

2
3 ORDINANCE BY THE RACINE COUNTY ECONOMIC DEVELOPMENT & LAND USE
4 PLANNING COMMITTEE TO REZONE FROM A-2 GENERAL FARMING & RESIDENTIAL
5 DISTRICT II TO M-4 QUARRYING DISTRICT

6
7 SECTION 7, T2N, R19E, TOWN OF BURLINGTON

8
9 OWNER: COUNTRYSIDE WOODS, LLC

10
11 APPLICANT: DLM TRANSPORTATION, LLC

12
13 AN ORDINANCE TO AMEND that Certain Ordinance Entitled RACINE COUNTY
14 ZONING ORDINANCE adopted December 2, 1969, found on pages 185 to
15 232 of the OFFICIAL PROCEEDINGS OF THE RACINE COUNTY BOARD OF
16 SUPERVISORS FOR THE YEAR 1969 as recodified May 28, 1991, by
17 Ordinance 91-196.

18
19 The County Board of Supervisors of the County of Racine ordains as
20 follows: Amend the Racine County Zoning Ordinance and change the
21 zoning district for the following described lands from A-2 General
22 Farming & Residential District II to M-4 Quarrying District

23
24 The South 1/2 of the Southeast 1/4 and the Northwest 1/4 of the
25 Southeast 1/4 of Section 7, Township 2 North, Range 19 East.

26 EXCEPTING THEREFROM the following:

27
28 EXCEPTION A1: A strip of land 2 rods wide off so much of the
29 South side as lies West of public highway.

30
31 EXCEPTION A2: Beginning at a point of intersection of the
32 South line of said Section 7 and intersection of public highway;
33 THENCE East along the South line of said Section 9 rods;
34 THENCE North 9 rods;
35 THENCE West to the center of McHenry Road (now County Trunk
36 Highway "P;"
37 THENCE Southerly along the center of road to the point of
38 beginning.

39
40 EXCEPTION A3: Beginning at the East 1/4 corner of said section;
41 THENCE South 7°01' West 1231.72 feet to a point in the
42 centerline of County Trunk Highway "P;"

43 THENCE South 16°49' West along the centerline of said highway
44 109.88 feet to a point on the East and West 1/18th line of the
45 Southeast 1/4 of said section and the place of beginning of land
46 hereinafter described;

47 THENCE South 89°31' West along the East and West 1/18th line,
48 440.62 feet to a point.

49 THENCE South 0°29' East, 446.52 feet to a point;

50 THENCE North 89°31' East, 351.70 feet to a point in the
51 centerline of said highway;

52 THENCE on an arc along the centerline of said highway, chord
53 of which is North 13°56' East (radius 2164.87 feet), 455.92 feet
54 to point on the East and West 1/18th line, and the place to
55 beginning.

4 EXCEPTION A4: That part of the Southeast ¼ of Section 7 and
5 the Southwest ¼ of Section 8 described as follows:

6 BEGINNING AT the Southeast corner of said Section 7;

7 THENCE South 89°16' West on the South line of said Section 7,
8 246.34 feet;

9 THENCE North 14°46' East, 191 feet;

10 THENCE North 89°53'54" West, 142.46 feet to the center of the
11 highway;

12 THENCE North 18°09' East, 22.08 feet;

13 THENCE North 89°16' East, 591.86 feet;

14 THENCE South 0°44' East, 221.90 feet;

15 THENCE South 89°06' West, 281.32 feet to the place of
16 beginning. All in Township 2 North, Range 19 East.

17 EXCEPTION A5: That part of the Southeast ¼ of Section 7,
18 Township 2 North, Range 19 East, of the 4th P.M., Township of
19 Burlington, County of Racine, State of Wisconsin and more
20 particularly described as follows:

21 BEGIN AT the Southeast corner of said Section 7;

22 RUN THENCE West along the South line of the Southeast ¼ of
23 Section 7, 385.81 feet;

24 THENCE North at right angles to the South line of the
25 Southeast ¼ of Section 7, 33.00 feet to a point in the centerline
26 of County Highway "P" and the place of beginning of parcel of land
27 hereinafter described;

28 RUN THENCE West, parallel with the South line of the Southeast
29 ¼ of Section 7 and 33 feet North thereof, a distance of 403.05
30 feet;

31 THENCE North at right angles to the South line of the
32 Southeast ¼ of Section 7, 272.0 feet;

33 THENCE South 72°49'20" East, 480.66 feet to the centerline of
34 County Highway "P;"

35 THENCE Southeasterly along the centerline of Highway "P" along
36 the arc of a curve convex Easterly and having a radius of 2282.01
37 feet and a chord of 140.91 feet which bears South 5°44'10 West to
38 the place of beginning.

39 SUBJECT TO the rights of the public over the East side for
40 highway purposes.

41
42 EXCEPTION A6: That part of the Southeast ¼ of Section 7 and that
43 part of the Southwest ¼ of Section 8, all in Township of
44 Burlington, county of Racine, State of Wisconsin, and more
45 particularly described as follows:

46 COMMENCE at a concrete monument at the Southwest corner of
47 Winkler's Woods, a plat of record;

48 THENCE North 72°50' West, along the extension of the Southerly
49 line of Oriole Circle, 33.00 feet to the centerline of County
50 Highway "P;"

51 THENCE South 17°10' West, 179.39 feet along centerline;

52 THENCE Southwesterly along said centerline 242.21 feet along
53 which bears South 13°55'21" West;

54 THENCE South 88°20'30" East, 473.00 feet;

55 THENCE due North 132.38 feet;

4 THENCE North 16°53'40" West, 218.12 feet to the South line of
5 Oriole Circle;

6 THENCE due West along the South line of Oriole Circle, 42.60
7 feet.

8
9
10 The official Racine County Zoning Map is hereby amended to conform
11 to this ordinance.

12
13 The Racine County Clerk is directed to transmit duplicate copies of
14 this ordinance by registered mail to the Burlington Town Clerk
15 within seven (7) days after this ordinance is adopted.

16
17 Respectfully submitted,
18 ECONOMIC DEVELOPMENT & LAND USE PLANNING COMMITTEE

19
20
21
22
23 _____
24 Robert D. Grove, Chair

25
26
27 _____
28 Mark M. Gleason, Vice Chair

29
30
31
32
33
34
35 _____
36 Daniel F. Sharkozy, Secretary

37
38 _____
39 Q. A. Shakoor, II

40
41
42
43
44
45
46 _____
47 Thomas Pringle

48
49 _____
50 Ken Hall

51
52
53
54
55
56
57 _____
58 John Wisch

59 VOTE REQUIRED: MAJORITY

60 BOARD ACTION:

61 1st Reading _____

62 Adopted _____

63 2nd Reading _____

64 For _____

65 Against _____

66 Absent _____

67 The Certificate of Publication, in compliance with State Statutes,
68 is available at Racine County Planning.

69 FISCAL NOTE - NOT APPLICABLE

70 NOTE: to allow a non-metallic mining operation, including
71 gravel crushing & washing & recycling of concrete/asphalt

72 NOTE: The Committee recommended approval of this petition as
73 this rezoning is compatible with surrounding zoning and
74 uses.
75
76
77

1
2
3
4
5
6
7

CITY
OF
BURLINGTON

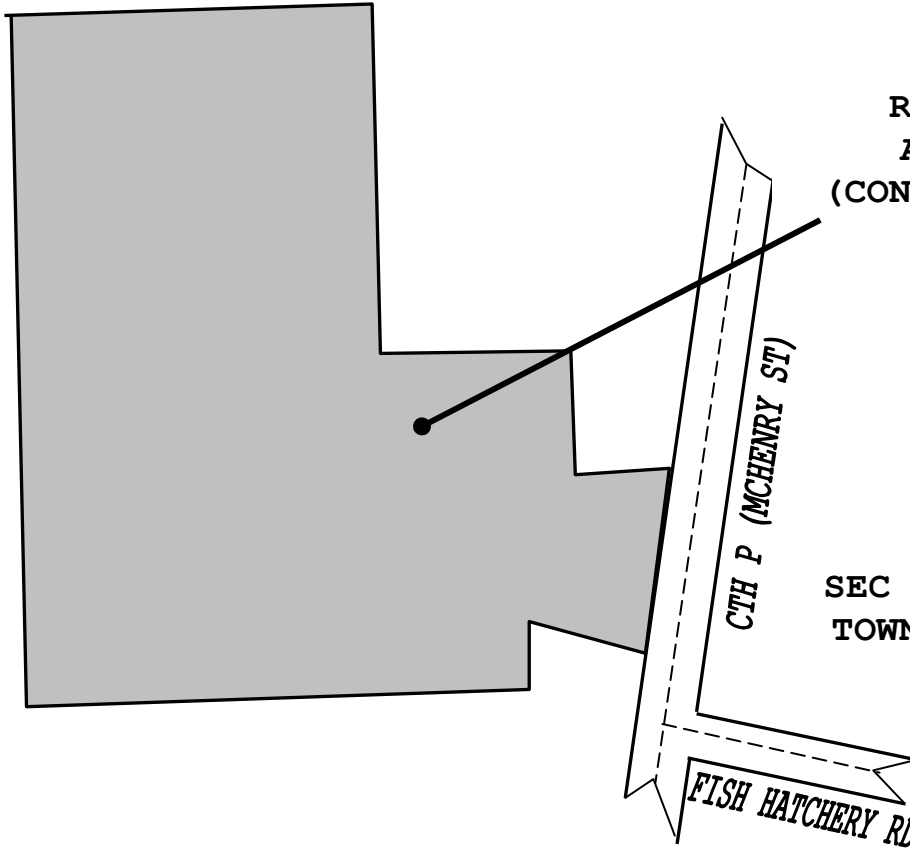

REZONE FROM
A-2 TO M-4
(CONTAINS 103 AC)

SEC 07 - T2N - R19E
TOWN OF BURLINGTON