

RESOLUTION NO. 2023-13

RESOLUTION BY THE PUBLIC WORKS, PARKS AND FACILITIES COMMITTEE AUTHORIZING RELOCATION AND ACQUISITION OF RIGHT-OF-WAY FOR A HIGHWAY IMPROVEMENT PROJECT AT THE INTERSECTION OF COUNTY TRUNK HIGHWAY (CTH) U AND 7 MILE ROAD IN THE VILLAGE OF RAYMOND

To the Honorable members of the Racine County Board of Supervisors:

BE IT RESOLVED by the Racine County Board of Supervisors that Racine County authorizes the proper improvement and maintenance of roadway at the intersection of County Trunk Highway (CTH) U and 7 Mile Road requiring certain relocation or changes and authorizes the acquisition of additional right-of-way and easements along those portions of CTH "U" and 7 Mile Road in the Village of Raymond.

BE IT FURTHER RESOLVED by the Racine County Board of Supervisors that under the authority granted by sections 32.05, 83.07, and 83.08 of the Wisconsin Statutes, the Racine County Board of Supervisors authorizes CTH "U" and 7 Mile Road to be relocated and that right-of-ways be acquired, in accordance with the plat attached hereto and incorporated herein as Exhibit "A". A copy of the plat shall be filed with the Racine County Clerk within twenty (20) days after its issue.

BE IT FURTHER RESOLVED by the Racine County Board of Supervisors that Corporation Counsel is authorized to prepare or review any agreement or other document, with the necessary and appropriate terms and conditions to facilitate this improvement.

BE IT FURTHER RESOLVED by the Racine County Board of Supervisors that any two of the County Executive, the County Clerk and/or the County Board Chairman are authorized to execute any contracts, agreements or other documents necessary to carry out the intent of this resolution.

Respectfully submitted,

PUBLIC WORKS, PARKS AND FACILITIES COMMITTEE

1st Reading _____

2nd Reading _____

BOARD ACTION

Tom Kramer, Chairman

Adopted _____

For _____

Against _____

Absent _____

Robert Grove, Vice-Chairman

1 Resolution No. 2023-13

2 Page Two

3

4

5

6

7 VOTE REQUIRED: Majority

Tom Hincz, Secretary

8

9 Prepared by:

10 Public Works & Development
11 Services Department

Eric Hopkins

12

13

Marlo Harmon

14

15

16

Edward Chart

17

18

19

Jessica Malacara

20

21

22 **The foregoing legislation adopted by the County Board of Supervisors of**
23 **Racine County, Wisconsin, is hereby:**

24

25 **Approved:** _____

26 **Vetoed:** _____

27

28 **Date:** _____,

29

30 _____
31 **Jonathan Delagrave, County Executive**

32

33

34 **WHEREAS**, Racine County is planning a highway improvement project and
35 construction of a roundabout at the intersection of CTH "U" and 7 Mile Road in the
36 Village of Raymond; and

37

38 **WHEREAS**, the Racine County Board of Supervisors authorized and entered into
39 a Statue Municipal Agreement (SMA) with the Wisconsin Department of Transportation
40 in Resolution 2020-100 with a first reading on January 26th, 2021 and a second reading
41 on February 9th, 2021; and

42

43 **WHEREAS**, this project requires certain relocation or changes and the
44 acquisition of certain right-of-way; and

45

46 **WHEREAS**, the Racine County Department of Public Works and Development
47 Services has funds available in the approved 2023 County Budget from Resolution
48 2022-0054 to purchase the required land interests in 460280.489000.RD436 in 2023.

**Amended Exhibit A
Resolution No. 2023-13**

TRANSPORTATION PROJECT PLAT NO: 2816-03-70-4.01

THAT PART OF LOTS 3, 4 AND 5 OF SPLITTER FARMS PLAT LOCATED IN PART OF THE NW1/4 OF THE NW1/4 OF SECTION 10, TOWNSHIP 4 NORTH, RANGE 21 EAST, AND LANDS IN PART OF SW1/4 OF THE SW 1/4 OF SECTION 3, TOWNSHIP 4 NORTH, RANGE 21 EAST, VILLAGE OF RAYMOND, RACINE COUNTY, WISCONSIN.

RELOCATION ORDER - CTH U/76TH ST INTERSECTION WITH 7 MILE ROAD, RACINE COUNTY TO PROVIDE ESTABLISH LAYOUT, WHEN ENLARGED, EXTENDED, RECONSTRUCTED, IMPROVED, OR MAINTAIN A PORTION OF THE HIGHWAY REQUIRING MAJOR RACINE COUNTY ENGINEERING AND CONSTRUCTION TO RELOCATE OR CHANGE SAID HIGHWAY AND ACQUIRE CERTAIN LANDS AND INTERESTS IN LANDS FOR THE ABOVE PROJECT.

TO EFFECT THE CHANGE, PURSUANT TO AUTHORITY GRANTED UNDER SECTION 83.03(1), WISCONSIN STATUTES, RACINE COUNTY ENGINEERS CERTIFY THAT:

- THE PORTION OF SAID HIGHWAY AS SHOWN ON THIS PLAT IS Laid OUT AND ESTABLISHED TO THE UNITS AND METHODS AS SO SPECIFIED FOR THE ABOVE PROJECT.
- THE LANDS OR INTERESTS OR RIGHTS IN LANDS AS SHOWN ON THIS PLAT ARE REQUIRED BY RACINE COUNTY FOR THE ABOVE PROJECT AND SHALL BE ACQUIRED BY THE WALK OF RACINE COUNTY, PURSUANT TO THE PROVISIONS OF SECTION 83.03(1), WISCONSIN STATUTES.

NOTES:

ADDITIONAL SURVEY ON THIS PLAT BY WISCONSIN COGNATE SURVEYING SYSTEM COGNATE (WISCONSIN) RACINE COUNTY ENGINEERS 10/15/23 IN 2 SURVEY FEET, WHICH SHOWS ARE IN RED ON THIS PLAT. ON BEARINGS AND DISTANCES, AND EXTENSIONS WERE USED AS GUIDING DISTANCES. ALL NEW EIGHT OF SAID HIGHWAY (LAYOUT) WILL BE THE 3 (THREE) 3/4" OF 1" REAR BEARING UNLESS OTHERWISE NOTED, AND WILL BE LACED FROM TO THE CENTERLINE OF THE PROJECT.

FOR THE LATEST ACCESS/ROADWAY INFORMATION, CONTACT THE RACINE COUNTY HIGHWAY DEPARTMENT.

EXISTING ACCESS CONTROL ALONG CTH U HAS BEEN ESTABLISHED FROM SPLITTER FARMS PLAT.

EXISTING RIGHT OF WAY SHOWN HEREIN IS BASED ON THE FOLLOWING POINTS OF REFERENCE FOR THIS AND 7.65 ACRES PORTION OF MAPS AT 1/4" = 60' SCALE, RACINE COUNTY PLATS OF SURVEY, 6658, 5566, 5206, 5 AND EXISTING CENTERLINE.

FOR ADDITIONAL INFORMATION REFER TO TITLE SHEET, RECORDED UNDER SHEET 2 OF 2.

THE STATION & OFFSET TABLE

POINT NO.	STATION	OFFSET
11E1500	10154.00	44.00
11E1501	10154.00	49.00
11E1502	10154.00	54.00
11E1503	10154.00	59.00
11E1504	10154.00	64.00
11E1505	10154.00	69.00
11E1506	10154.00	74.00
11E1507	10154.00	79.00
11E1508	10154.00	84.00
11E1509	10154.00	89.00
11E1510	10154.00	94.00
11E1511	10154.00	99.00
11E1512	10154.00	104.00
11E1513	10154.00	109.00
11E1514	10154.00	114.00
11E1515	10154.00	119.00
11E1516	10154.00	124.00
11E1517	10154.00	129.00
11E1518	10154.00	134.00
11E1519	10154.00	139.00
11E1520	10154.00	144.00
11E1521	10154.00	149.00
11E1522	10154.00	154.00
11E1523	10154.00	159.00
11E1524	10154.00	164.00
11E1525	10154.00	169.00
11E1526	10154.00	174.00
11E1527	10154.00	179.00
11E1528	10154.00	184.00
11E1529	10154.00	189.00
11E1530	10154.00	194.00
11E1531	10154.00	199.00
11E1532	10154.00	204.00
11E1533	10154.00	209.00
11E1534	10154.00	214.00
11E1535	10154.00	219.00
11E1536	10154.00	224.00
11E1537	10154.00	229.00
11E1538	10154.00	234.00
11E1539	10154.00	239.00
11E1540	10154.00	244.00
11E1541	10154.00	249.00
11E1542	10154.00	254.00
11E1543	10154.00	259.00
11E1544	10154.00	264.00
11E1545	10154.00	269.00
11E1546	10154.00	274.00
11E1547	10154.00	279.00
11E1548	10154.00	284.00
11E1549	10154.00	289.00
11E1550	10154.00	294.00
11E1551	10154.00	299.00
11E1552	10154.00	304.00
11E1553	10154.00	309.00
11E1554	10154.00	314.00
11E1555	10154.00	319.00
11E1556	10154.00	324.00
11E1557	10154.00	329.00
11E1558	10154.00	334.00
11E1559	10154.00	339.00
11E1560	10154.00	344.00
11E1561	10154.00	349.00
11E1562	10154.00	354.00
11E1563	10154.00	359.00
11E1564	10154.00	364.00
11E1565	10154.00	369.00
11E1566	10154.00	374.00
11E1567	10154.00	379.00
11E1568	10154.00	384.00
11E1569	10154.00	389.00
11E1570	10154.00	394.00
11E1571	10154.00	399.00
11E1572	10154.00	404.00
11E1573	10154.00	409.00
11E1574	10154.00	414.00
11E1575	10154.00	419.00
11E1576	10154.00	424.00
11E1577	10154.00	429.00
11E1578	10154.00	434.00
11E1579	10154.00	439.00
11E1580	10154.00	444.00
11E1581	10154.00	449.00
11E1582	10154.00	454.00
11E1583	10154.00	459.00
11E1584	10154.00	464.00
11E1585	10154.00	469.00
11E1586	10154.00	474.00
11E1587	10154.00	479.00
11E1588	10154.00	484.00
11E1589	10154.00	489.00
11E1590	10154.00	494.00
11E1591	10154.00	499.00
11E1592	10154.00	504.00
11E1593	10154.00	509.00
11E1594	10154.00	514.00
11E1595	10154.00	519.00
11E1596	10154.00	524.00
11E1597	10154.00	529.00
11E1598	10154.00	534.00
11E1599	10154.00	539.00
11E1600	10154.00	544.00

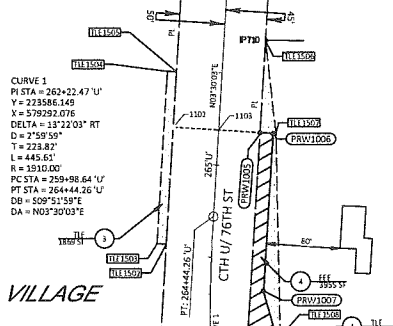

EXISTING MONUMENTS

POINT	Y (NORTHING)	X (EASTING)	DESCRIPTION
11E1500	22480.104	57928.544	1/4" IRON ROD FOUND
11E1501	22542.161	57985.506	1/4" IRON ROD FOUND
11E1502	22443.877	57925.993	1/4" IRON ROD FOUND
11E1503	22544.635	57985.570	1/4" IRON ROD FOUND
11E1504	22358.767	57925.996	1/4" IRON ROD FOUND
11E1505	22552.285	57928.506	1/4" IRON ROD FOUND
11E1506	22552.285	57928.506	1/4" IRON ROD FOUND
11E1507	22442.973	57925.938	1/4" IRON ROD FOUND
11E1508	22542.007	57985.542	1/4" IRON ROD FOUND
11E1509	22358.066	57925.938	1/4" IRON ROD FOUND
11E1510	22552.285	57928.506	1/4" IRON ROD FOUND
11E1511	22358.066	57925.938	1/4" IRON ROD FOUND
11E1512	22552.285	57928.506	1/4" IRON ROD FOUND

SCHEDULE OF LANDS & INTERESTS REQUIRED

OWNER'S NAMES ARE SHOWN FOR REFERENCE PURPOSES ONLY AND ARE SUBJECT TO CHANGE PRIOR TO THE TRANSFER OF LANDS INTERESTS TO THE COUNTY OF RACINE.

PARCEL NUMBER	OWNERS	INTERESTS REQUIRED	RAW SQ. FEET	TITLE
1	DAVID D'ANGELO	FE/FE	---	914
2	TERESA JANE BUCHART AND ANITA W. MORRISON	FE/FE	1883	1381
3	SANDRA J. VOLLNER AND LORNE E. BODROS	FE/FE	4399	1399
4	ROBERT H. REBERNICK, DEBITOR IN POSSESSION UNDER CASE NO. 19-6000-BE, PENDING IN THE US BANKRUPTCY COURT FOR THE EASTERN DISTRICT OF WISCONSIN.	FE/FE	8879	6705
5	NIKHAR W. WILKOMM AND CATHERINE E. WILKOMM	FE/FE	6476	3359

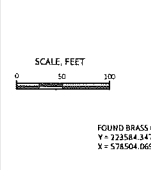

COURSE TABLE

COURSE	BEARINGS	DISTANCE
11E1500-11E1501	N00° 00' 00" W	5.00
11E1501-11E1502	N00° 00' 00" W	5.00
11E1502-11E1503	S89° 24' 26" E	24.74
11E1503-11E1504	N00° 00' 00" W	5.00
11E1504-11E1505	N00° 00' 00" W	5.00
11E1505-11E1506	N00° 00' 00" W	5.00
11E1506-11E1507	N00° 00' 00" W	5.00
11E1507-11E1508	N00° 00' 00" W	5.00
11E1508-11E1509	N00° 00' 00" W	5.00
11E1509-11E1510	N00° 00' 00" W	5.00
11E1510-11E1511	N00° 00' 00" W	5.00
11E1511-11E1512	N00° 00' 00" W	5.00
11E1512-11E1513	N00° 00' 00" W	5.00
11E1513-11E1514	N00° 00' 00" W	5.00
11E1514-11E1515	N00° 00' 00" W	5.00
11E1515-11E1516	N00° 00' 00" W	5.00
11E1516-11E1517	N00° 00' 00" W	5.00
11E1517-11E1518	N00° 00' 00" W	5.00
11E1518-11E1519	N00° 00' 00" W	5.00
11E1519-11E1520	N00° 00' 00" W	5.00
11E1520-11E1521	N00° 00' 00" W	5.00
11E1521-11E1522	N00° 00' 00" W	5.00
11E1522-11E1523	N00° 00' 00" W	5.00
11E1523-11E1524	N00° 00' 00" W	5.00
11E1524-11E1525	N00° 00' 00" W	5.00
11E1525-11E1526	N00° 00' 00" W	5.00
11E1526-11E1527	N00° 00' 00" W	5.00
11E1527-11E1528	N00° 00' 00" W	5.00
11E1528-11E1529	N00° 00' 00" W	5.00
11E1529-11E1530	N00° 00' 00" W	5.00
11E1530-11E1531	N00° 00' 00" W	5.00
11E1531-11E1532	N00° 00' 00" W	5.00
11E1532-11E1533	N00° 00' 00" W	5.00
11E1533-11E1534	N00° 00' 00" W	5.00
11E1534-11E1535	N00° 00' 00" W	5.00
11E1535-11E1536	N00° 00' 00" W	5.00
11E1536-11E1537	N00° 00' 00" W	5.00
11E1537-11E1538	N00° 00' 00" W	5.00
11E1538-11E1539	N00° 00' 00" W	5.00
11E1539-11E1540	N00° 00' 00" W	5.00
11E1540-11E1541	N00° 00' 00" W	5.00
11E1541-11E1542	N00° 00' 00" W	5.00
11E1542-11E1543	N00° 00' 00" W	5.00
11E1543-11E1544	N00° 00' 00" W	5.00
11E1544-11E1545	N00° 00' 00" W	5.00
11E1545-11E1546	N00° 00' 00" W	5.00
11E1546-11E1547	N00° 00' 00" W	5.00
11E1547-11E1548	N00° 00' 00" W	5.00
11E1548-11E1549	N00° 00' 00" W	5.00
11E1549-11E1550	N00° 00' 00" W	5.00
11E1550-11E1551	N00° 00' 00" W	5.00
11E1551-11E1552	N00° 00' 00" W	5.00
11E1552-11E1553	N00° 00' 00" W	5.00
11E1553-11E1554	N00° 00' 00" W	5.00
11E1554-11E1555	N00° 00' 00" W	5.00
11E1555-11E1556	N00° 00' 00" W	5.00
11E1556-11E1557	N00° 00' 00" W	5.00
11E1557-11E1558	N00° 00' 00" W	5.00
11E1558-11E1559	N00° 00' 00" W	5.00
11E1559-11E1560	N00° 00' 00" W	5.00

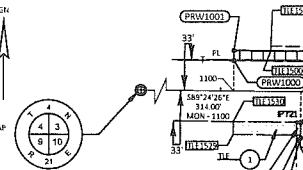

STATION & OFFSET TABLE

POINT NO.	STATION	OFFSET
11E1500	10154.00	0.00
11E1501	10154.00	5.00
11E1502	10154.00	10.00
11E1503	10154.00	15.00
11E1504	10154.00	20.00
11E1505	10154.00	25.00
11E1506	10154.00	30.00
11E1507	10154.00	35.00
11E1508	10154.00	40.00
11E1509	10154.00	45.00
11E1510	10154.00	50.00
11E1511	10154.00	55.00
11E1512	10154.00	60.00
11E1513	10154.00	65.00
11E1514	10154.00	70.00
11E1515	10154.00	75.00
11E1516	10154.00	80.00
11E1517	10154.00	85.00
11E1518	10154.00	90.00
11E1519	10154.00	95.00
11E1520	10154.00	100.00
11E1521	10154.00	105.00
11E1522	10154.00	110.00
11E1523	10154.00	115.00
11E1524	10154.00	120.00
11E1525	10154.00	125.00
11E1526	10154.00	130.00
11E1527	10154.00	135.00
11E1528	10154.00	140.00
11E1529	10154.00	145.00
11E1530	10154.00	150.00
11E1531	10154.00	155.00
11E1532	10154.00	160.00
11E1533	10154.00	165.00
11E1534	10154.00	170.00
11E1535	10154.00	175.00
11E1536	10154.00	180.00
11E1537	10154.00	185.00
11E1538	10154.00	190.00
11E1539	10154.00	195.00
11E1540	10154.00	200.00
11E1541	10154.00	205.00
11E1542	10154.00	210.00
11E1543	10154.00	215.00
11E1544	10154.00	220.00
11E1545	10154.00	225.00
11E1546	10154.00	230.00
11E1547	10154.00	235.00
11E1548	10154.00	240.00
11E1549	10154.00	245.00
11E1550	10154.00	250.00
11E1551	10154.00	255.00
11E1552	10154.00	260.00
11E1553	10154.00	265.00
11E1554	10154.00	270.00
11E1555	10154.00	275.00
11E1556	10154.00	2

