

Exhibit C - Project Program

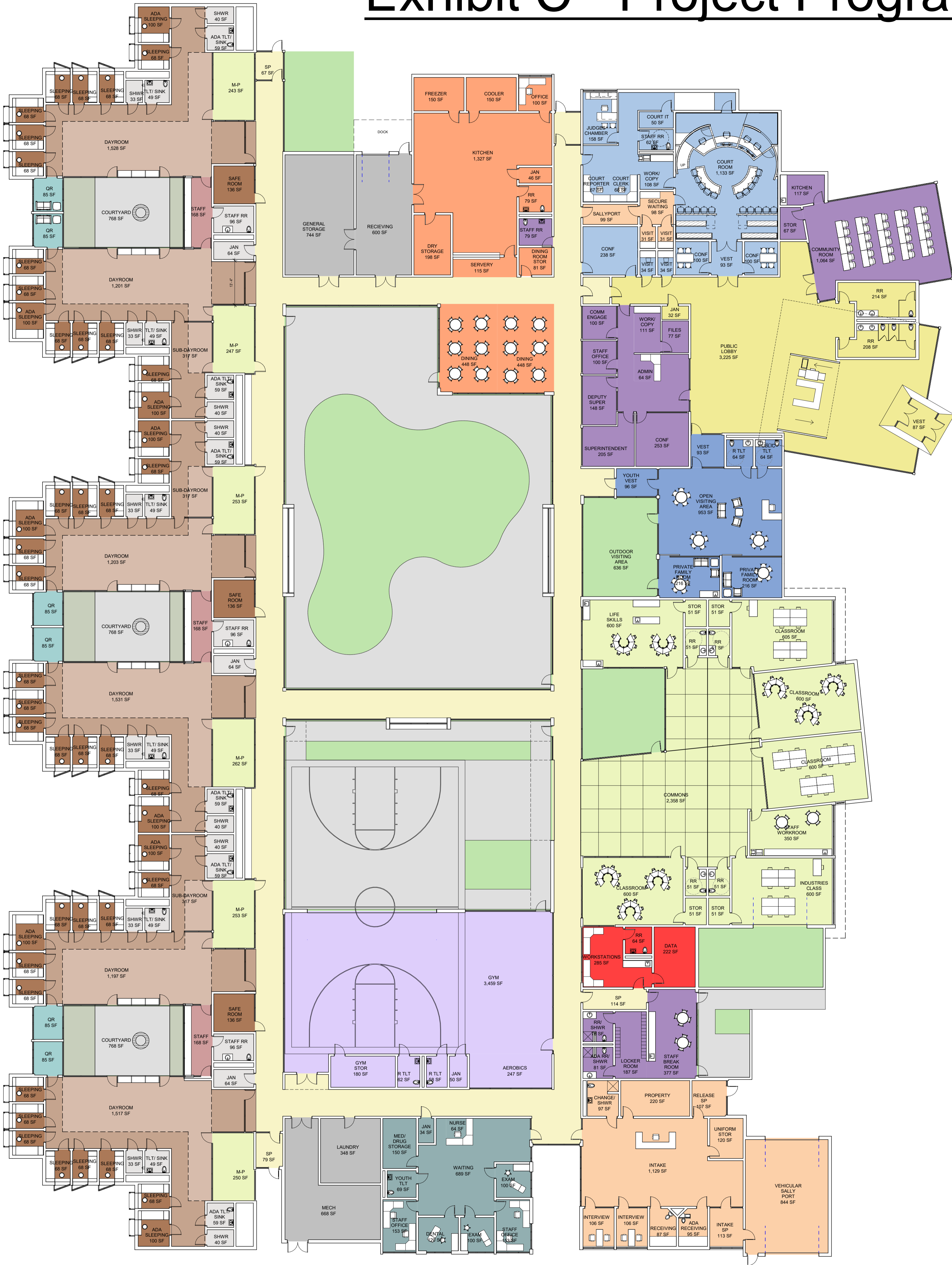

Exhibit C - Project Program



Exhibit C - Project Program

Youth Development and Care Center Program

Room/Space	20 FEB PROGRAM				22 OCT WORKSHOP				ACTUAL REDUCTIONS
	Qty	SF/ Room	Net SF	Totals	Qty	SF/ Room	Net SF	Totals	
1 Public and Administration				7,305 sf				5,612 sf	
Vestibule	1	120	120		1	120	120		
Lobby	1	2,560	2,560		1	1,800	1,800		760
Public Toilet	2	171	342		2	171	342		
Master Control									
Master Control Workstations	1	305	305		1	216	216		89
Master C. E. R.	1	0	-		1	0	-		
Data center	1	354	354		1	222	222		132
Staff toilet	1	59	59		1	64	64		(5)
Entry sallyport	1	48	48		1	64	64		(16)
Administration Suite									
Administrative support workstation	1	78	78		1	80	80		
Conference Room	1	252	252		1	252	252		
Superintendent	1	188	188		1	188	188		
Deputy Super.	1	137	137		1	137	137		
Community Engagement Office	1	100	100		1	100	100		
Staff Office	1	100	100		1	100	100		
Kitchen/Breakroom	1	0	-		1	0	-		
Workroom / Files / Storage	1	72	72		1	72	72		
Files	1	67	67		1	67	67		
Workroom / Stor.	1	0	-		1	0	-		
Community Room / Training	1	978	978		1	978	978		
Kitchenette	1	0	-		1	0	-		
Storage	1	111	111		1	111	111		
Staff Break/ Entry									
Staff Breakroom	1	284	284		1	307	307		(23)
Staff toilet	0	0	-		0	0	-		
Male Staff Locker /Showers /Toilet	1	0	-		1	0	-		
Female Staff Locker /Showers /Toilet	1	0	-		1	0	-		
Locker Room	1	359	359		1	232	232		127
ADA Shower/ Changing Room	2	81	162		2	80	160		2
Shower/ Changing Room	2	69	138		0	69	-		138
Sub-Total			6,814				5,612		1,204
Circulation Grossing Factor			491						
2 Family Visitation			1,810 sf				1,700 sf		
Screening/Public Vestibule	1	107	107		1	107	107		
Youth Sallyport / Screening	1	94	94		1	81	81		13
Open Visiting Area	1	800	800		1	700	1,000		(200)
Family Visiting MP Room	0	0	-		0	0	-		
Storage	1	0	-		1	0	-		
Kitchenette	1	0	-		1	0	-		
Resident Toilet	2	60	120		1	60	60		60
Visitor Toilet	1	65	65		1	63	63		2
Private Visiting Room	2	113	226		0	98	-		226
Private Visiting Room	1	208	208		1	193	193		15
Private Visiting suite	1	190	190		1	196	196		(6)
Family Room	1	190	190		1	196	196		
Outdoor Visiting	1	488	488		1	346	346		
Sub-Total			1,810				1,700		110
Circulation Grossing Factor			0						
3 Court			4,615 sf				3,156 sf		
Court Room	1	1,200	1,200		1	1,140	1,140		60
Waiting	1	703	703		1	755	755		(52)
Court Vestibule	1	87	87		1	87	87		
Att./Client Conference Room	2	100	200		2	100	200		
Conference Room	1	101	150		0	101	-		150
Public toilets	2	67	134		2	72	144		(10)
Evidence holding	1	64	64		0	64	-		64
Court AV/IT	1	53	53		1	53	53		
Sallyport	1	122	122		1	89	89		33
Secure waiting	1	171	171		1	144	144		27
Secure Attorney meeting	4	30	120		4	30	120		
Janitor / Storage	1	40	40		1	40	-		
Judge's Chamber	1	224	224		1	150	150		74
Judge toilet	1	49	49		1	0	-		49
Court Clerk	1	64	64		1	64	64		
Court Reporter	1	64	64		1	64	64		
Copier/Workroom	1	59	59		1	91	91		(32)
Staff toilet	1	67	67		1	55	55		12
Sub-Total			3,571				3,156		375
Circulation Grossing Factor			1,044						
4 Education			7,101 sf				4,397 sf		
General Classroom(s)	2	558	1,116		4	600	2,400		475
General Classroom(s)	1	653	653		0	-	-		
General Classroom(s)	1	554	554		0	-	-		
General Classroom(s)	1	552	552		0	-	-		
Industries Classroom	1	604	604		1	604	604		
Industries Storage	1	48	48		1	48	48		
Culinary / Life Skills Classroom	1	541	541		1	541	541		
Quiet Room	1	68	68		1	68	68		
Resident Toilet	2	64	128		2	64	128		
Resident Toilet	2	53	106		2	57	114		(8)
Vestibule/ SP	1	75	75		1	75	-		
Volunteer / Teachers Workroom	1	638	638		1	395	395		243
Staff Toilet	1	65	65		1	59	59		6
Janitor Closet	1	88	88		1	40	40		48
Sub-Total			5,236				4,397		764
Circulation Grossing Factor			1,865						
5 Recreation / Programs			4,069 sf				4,069 sf		
HS Court Gym	1	3,468	3,468		1	3,468	3,468		
Gym Storage	1	180	180		1	180	180		
Aerobic Room	1	247	247		1	247	247		
Resident Toilet	2	62	124		2	62	124		
Janitor Closet	1	50	50		1	50	50		
Sub-Total			4,069				4,069		-
Circulation Grossing Factor			-				-		
6 Kitchen and Dining			3,088 sf				2,988 sf		
Kitchen	1	1,161	1,161		1	1,082	1,082		79
Cooler Storage	1	152	152		1	152	152		
Freezer Storage	1	152	152		1	152	152		
Dry Storage	1	239	239		1	162	162		77
Office	1	101	101		1	103	103		(2)
Staff Toilet	1	63	63		1	73	73		(10)
Janitor Closet	1	49	49		1	73	73		(24)
Servery	1	279	279		1	225	225		54
Dining Room	2	404	808		2	413	826		(18)
Dining Room Storage	1	84	84		1	140	140		(56)
Sub-Total			3,088				2,988		100
Circulation Grossing Factor			0				0		
7 Health			1,463 sf				1,272 sf		
Waiting	1	402	402		1	315	315		87
Exam Room	2	120	240		2	98	196		44
Resident Toilet	1	55	55		1	59	59		(4)
Dental Procedure Room	1	121	121		1	120	120		1
Staff Offices	2	185	370		1	150	150		220
Staff Offices	1	154	154		1	154	154		(154)
Nurse station	1	48	48		1	64	64		(16)
Medical storage / drug storage	1	165	165		1	150	150		15
Staff Toilet	1	62	62		1	64	64		(2)
Sub-Total			1,463				1,272		191

Exhibit C - Project Program

Room/Space	Qty	SF/ Room	Net SF	Totals	Qty	SF/ Room	Net SF	Totals	
Circulation Grossing Factor			0				0		
8 Intake				3,056 sf				2,424 sf	
Vehicle Sally Port (Garage)	1	863	863		1	861	861		2
Sallyport entry	1	95	95		1	64	64		31
Interview Room	2	100	200		1	2	2		198
Interview Room							-		
Booking Area	1	1,184	1,184		1	772	772		412
Receiving room(s)	2	80	160		1	97	97		63
Receiving room(s)					1	90	90		
Changing / Shower	1	67	67		1	69	69		(2)
Youth Toilet	1	61	61		1	0	-		61
Release sallyport	1	71	71		1	127	127		(56)
Property Storage	1	235	235		1	220	220		15
Uniform Storage	1	120	120		1	122	122		(2)
Sub-Total			3,056				2,424		632
Circulation Grossing Factor			0						
9 Support				3,209 sf				3,209 sf	
Laundry	1	351	351		1	351	351		
Building Receiving (Dock)	1	400	400		1	400	400		
Trash	1	400	400		1	400	400		
General Storage	1	582	582		1	582	582		
General Storage	1	280	280		1	280	280		
Mechanical	1	294	294		1	294	294		
Mechanical	1	585	585		1	585	585		
Mechanical	1	317	317		1	317	317		
Sub-Total			3,209				3,209		0
Circulation Grossing Factor			0				0		

Exhibit C - Project Program

Room/Space	Qty	SF/ Room	Net SF	Totals	Qty	SF/ Room	Net SF	Totals	
Program Component									
1 Public and Administration				7,305				5,612	1,204
2 Family Visitation				1,810				1,700	110
3 Court				4,615				3,156	375
4 Education				7,101				4,397	764
5 Recreation / Programs				4,069				4,069	0
6 Kitchen and Dining				3,088				2,988	100
7 Health				1,463				1,272	191
8 Intake				3,056				2,424	632
9 Support				3,209				3,209	0
Base Building Subtotals.....				35,716				28,827	3,376
Circulation and Walls				18,553				18,553	
Juvenile Departments Total				35,716				28,827	
Housing Total				16,560				16,560	
TOTAL				70,829				63,940	