

# INTERIOR COURTROOM RENOVATION FOR: RACINE COUNTY LAW ENFORCEMENT CENTER

717 WISCONSIN AVE ♦ RACINE, WI 53403

## APPLICABLE CODES

ALL CONSTRUCTION SHALL BE EXECUTED IN CONFORMANCE WITH THE FOLLOWING:

**BUILDING CODE:**

- 2015 INTERNATIONAL BUILDING CODE (IBC) W/ WISCONSIN AMENDMENTS SPS 362
- 2015 INTERNATIONAL EXISTING BUILDING CODE (IEBC) W/ WISCONSIN AMENDMENTS SPS 366

**ACCESSIBILITY CODE:**

- 2015 INTERNATIONAL BUILDING CODE (IBC) W/ WISCONSIN AMENDMENTS SPS 362
- 2009 ICC (ANSI A117) ACCESSIBLE AND USABLE BUILDINGS AND FACILITIES

**ENERGY CODE:**

- 2015 INTERNATIONAL ENERGY CONSERVATION CODE (IECC) W/ WISCONSIN AMENDMENTS SPS 364

- GOVERNING LOCAL AND MUNICIPAL CODES

## GENERAL NOTES

- THE FOLLOWING GENERAL AND SPECIFIC NOTES SHALL APPLY EQUALLY TO ALL CONTRACTORS AND SUPPLIERS ENGAGED IN EXECUTION OF THE WORK SHOWN ON THESE PLANS. THESE NOTES SUPPLEMENT AND ARE MADE A PART OF THE ENTIRE CONTRACT DOCUMENTS.
- ALL CONSTRUCTION SHALL BE EXECUTED IN CONFORMANCE WITH THE FOLLOWING:
  - PLANS AND SPECIFICATIONS
  - LATEST EDITION OF WISCONSIN ENROLLED COMMERCIAL BUILDING CODE.
  - GOVERNING LOCAL AND MUNICIPAL CODES
  - STATE OF WISCONSIN DNR
  - OSHA AND EPA REQUIREMENTS
  - ANSI 111 - ACCESSIBLE & USABLE BUILDINGS AND FACILITIES

**CONCRETE CONSTRUCTION:**

  - AMERICAN CONCRETE INSTITUTE STRUCTURAL AND MISCELLANEOUS STEEL WORK
  - AMERICAN INSTITUTE OF STEEL CONSTRUCTION, CODE OF STANDARD PRACTICE

**STEEL JOISTS AND ACCESSORIES:**

  - STEEL JOIST INSTITUTE

CONTRACTOR SHALL INSURE FAMILIARITY OF THE ABOVE ITEMS. ARCHITECT INSPECTIONS SHALL BE IN CONFORMANCE WITH THE ABOVE.
- CONTRACTOR TO CROSS CHECK DIMENSIONS AND ELEVATIONS BETWEEN ARCHITECTURAL, MECHANICAL, AND STRUCTURAL PLANS. ARCHITECT TO BE NOTIFIED OF ANY VARIANCE BEFORE CONTRACTOR BEGINS WORK. ALL EQUIPMENT SUPPORTS & ANCHORAGES TO BE CROSS CHECKED WITH MANUFACTURER'S DRAWINGS. CONTRACTOR SHALL VERIFY ALL PROFILES HEIGHTS, AND DIMENSIONS AT PROJECT PRIOR TO FABRICATION OF ANY MATERIAL AND INFORM THE ENGINEER OF ANY DISCREPANCIES OR FRAMING INTERFERENCES.
- REFER TO ALL ARCHITECTURAL, STRUCTURAL, MECHANICAL, AND ELECTRICAL PLANS FOR DETAILS OF CONSTRUCTION.
- ALL OPENINGS FOR PLUMBING, ELECTRICAL, HVAC, OR FIRE PROTECTION CONDUIT, PIPING, OR DUCTWORK ARE TO BE REPAIRED BY THE ASSOCIATED TRADE. ALL TRADES SHALL TAKE CARE TO MAKE HOLES ONLY AS LARGE AS NECESSARY. ALL OPENINGS SHALL BE NEATLY CUT. DO NOT PUNCH OR POUND HOLES IN WALL OR ROOF DECK.
- IN NO CASE SHALL STRUCTURAL ALTERATIONS OR WORK AFFECTING A STRUCTURAL MEMBER BE MADE, UNLESS APPROVED BY ARCHITECT. MECHANICAL TRADES MUST SUBMIT LAYOUTS OF ALL RISES/PASSES THROUGH STRUCTURAL MEMBERS FOR ARCHITECT'S APPROVAL.
- ASSOCIATED TRADE CONTRACTOR SHALL BE RESPONSIBLE FOR ANY OPENINGS LEFT UNREPAIRED AND WILL BE BACK CHARGED ACCORDINGLY FOR SUCH REPAIRS.
- ALL OPENINGS OR PENETRATIONS THROUGH FIRE RATED CONSTRUCTION SHALL BE APPROPRIATELY FIRE STOPPED, DAMPERED, OR SEALED AS REQ'D BY CODE.
- ALL CONSTRUCTION MATERIALS TO BE NEW UNLESS SPECIFICALLY NOTED OTHERWISE.
- SHOP DRAWINGS - SUBMIT MINIMUM OF FIVE (5) COPIES FOR APPROVAL ON ALL ITEMS OF EQUIPMENT FURNISHED AS A PART OF THIS PROJECT -OR- ONE (1) SET ELECTRONICALLY. ARCHITECT APPROVAL DOESN'T RELIEVE THE CONTRACTOR OF ANY RESPONSIBILITY FOR CORRECTNESS, FIT OR STRENGTH OF DETAILS. SHOP DRAWINGS MUST CLEARLY SHOW DETAILS FOR ACCURATE PLACING OF REINFORCING STEEL, STRUCTURAL STEEL, ETC. CONTRACTOR SHALL REVIEW AND STAMP ALL SHOP DRAWINGS BEFORE SUBMITTING TO ARCHITECT. CONTRACTOR SHALL ALLOW MINIMUM OF ONE WEEK FOR REVIEW OF SHOP DRAWINGS.
- WHERE SECTIONS OR NOTES ARE CALLED FOR IN A CERTAIN PORTION OF THE BUILDING, IT SHALL BE DUPLICATED IN SIMILAR PORTIONS OF THE BUILDING, UNLESS NOTED OTHERWISE.
- EACH CONTRACTOR IS TO OBTAIN AND PAY FOR PERMITS, LICENSES, FEES, ETC. AS MAY BE REQ'D FOR COMPLETION OF HIS PORTION OF THE PROJECT. EACH CONTRACTOR SHALL COORDINATE HIS WORK WITH OTHER CONTRACTORS, AND ALL OTHERS AT THE SITE. EACH CONTRACTOR SHALL INCLUDE NECESSARY DEMOLITION AND REMOVAL OF ALL MATERIAL AS REQ'D TO PERFORM HIS WORK.
- ANY HAZARDOUS MATERIALS ENCOUNTERED DURING DEMOLITION, REMODELING, OR EXCAVATION SHALL BE REMOVED AND/OR CONTAINED IN ACCORDANCE WITH ALL GOVERNING LOCAL, STATE, AND FEDERAL REGULATIONS. NOTIFY ARCHITECT, REMOVAL BY OWNER.
- DO NOT SCALE DRAWINGS
- ALL DIMENSIONS AND ELEVATIONS MUST BE VERIFIED BY CONTRACTOR TO CONFORM WITH THOSE SHOWN ON PLANS.
- IN NO CASE SHALL STRUCTURAL ALTERATIONS OR WORK AFFECTING A STRUCTURAL MEMBER BE MADE, UNLESS APPROVED BY THE ARCHITECT.
- IT IS SOLELY THE CONTRACTOR'S RESPONSIBILITY TO DETERMINE ERECTION PROCEDURE AND SEQUENCE IN ORDER TO INSURE THE SAFETY OF THE BUILDING, WORKMEN, AND OCCUPANTS DURING ERECTION. THIS INCLUDES BUT IS NOT LIMITED TO THE ADDITION OF TEMPORARY BRACING, GUYS OR TIE-DOWNS AS NECESSARY. ALL CONSTRUCTION AND ERECTION MUST CONFORM TO OSHA REQ'D.
- WHERE DETAILS ARE CALLED FOR IN ONE PORTION OF THE BUILDING, THEY SHALL BE DUPLICATED IN SIMILAR PORTIONS OF THE BUILDING.
- DESIGN DRAWINGS SHALL NOT BE USED AS SHOP DRAWINGS.
- REMOVE AND REPLACE ALL EXISTING CONSTRUCTION (ELECTRICAL, MECHANICAL, HVAC, AND ARCHITECTURAL) AS REQ'D IN ORDER TO PLACE NEW STRUCTURAL WORK SHOWN ON THESE DRAWINGS.
- IN THE EVENT OF ANY CONFLICT BETWEEN PLANS, DETAILS, STRUCTURAL NOTES, AND SPECIFICATIONS, CONTRACTOR SHALL BRING THE CONFLICT TO THE ARCHITECT'S ATTENTION OR SHALL BID THE MOST EXPENSIVE ITEM.

## PAINTING

**MATERIALS AND COLORS:**

SPECIFICATIONS FOR ALL PAINTS ARE BASED ON SHERWIN-WILLIAMS CO. ALL COLORS SHALL BE AS SELECTED BY ARCHITECT FROM SAMPLES PROVIDED BY PAINTING CONTRACTOR. OTHER PAINT MANUFACTURER'S PRODUCTS MAY BE USED AT CONTRACTOR'S OPTION OR AS CALLED FOR IN PLANS.

**JOB CONDITIONS:**

APPLY WATER-BASE PAINTS ONLY WHEN TEMPERATURE OF SURFACES TO BE PAINTED AND SURROUNDING AIR TEMPERATURES ARE BETWEEN 45° AND 90° F, UNLESS OTHERWISE PERMITTED BY PAINT MANUFACTURER'S PRINTED INSTRUCTIONS.

APPLY SOLVENT-BASE PAINTS ONLY WHEN TEMPERATURE OF SURFACES TO BE PAINTED AND SURROUNDING AIR TEMPERATURES ARE BETWEEN 45° AND 90° F, UNLESS OTHERWISE PERMITTED BY PAINT MANUFACTURER'S PRINTED INSTRUCTIONS.

DO NOT APPLY PAINT IN SNOW, RAIN, FOG, OR MIST. DO NOT APPLY PAINT WHEN RELATIVE HUMIDITY EXCEEDS 85%. DO NOT APPLY PAINT TO WET OR DAMP SURFACES.

**PAINTING SCHEDULE:**

**INTERIOR GYPSUM BOARD:**

1ST COAT---FROM/AR 400 LATEX WALL PRIMER B20U400 AT 2.0 MILS DFT  
2ND COAT---FROM/AR 400 LATEX EGGSHELL ENAMEL B30U401 AT 1.2 MILS DFT

**INTERIOR METALS:**

1ST COAT---FROM/AR 400 LATEX WALL PRIMER B20U400 AT 2.0 MILS DFT  
2ND COAT---FROM/AR 400 LATEX EGGSHELL ENAMEL B30U401 AT 1.2 MILS DFT

**INSPECTION:**

APPLICATOR MUST EXAMINE AREAS AND CONDITIONS UNDER WHICH PAINTING WORK IS TO BE APPLIED AND NOTIFY CONTRACTOR IN WRITING OF CONDITIONS DETRIMENTAL TO PROPER AND TIMELY COMPLETION OF WORK. DO NOT PROCEED WITH WORK UNTIL UNSATISFACTORY CONDITIONS HAVE BEEN CORRECTED TO A MANNER ACCEPTABLE TO THE APPLICATOR.

STARTING OF PAINTING WORK WILL BE CONSIDERED AS APPLICATOR'S ACCEPTANCE OF SURFACES AND EXISTING SURFACES. PREPARATION OF EXISTING SURFACES TO RECEIVE PAINTING SHALL BE CONTRACTOR'S CONDITIONS WITHIN ANY PARTICULAR AREA.

DO NOT PAINT OVER DIRT, RUST, SCALE, GREASE, MOISTURE, SOILED SURFACES, OR CONDITIONS OTHERWISE DETRIMENTAL TO FORMATION OF A DURABLE PAINT FILM.

**SURFACE PREPARATION:**

GENERAL: PERFORM PREPARATION AND CLEANING PROCEDURES IN ACCORDANCE WITH PAINT MANUFACTURER'S INSTRUCTIONS AND AS HEREIN SPECIFIED, FOR EACH PARTICULAR SUBSTRATE CONDITION.

RESPONSIBILITY: IN ADDITION TO PREPARATION STATED ABOVE, REMOVE AND REPLACE ANY EXISTING ATTACHMENTS TO EXISTING SURFACES THAT REQUIRE FINISHING IF SAID ATTACHMENTS ARE NOT TO BE PAINTED WITH WALL. WASH EXISTING SURFACES REMOVE ALL LOOSE BLISTERS, OR OTHERWISE DEFECTIVE PAINT OR VARNISH. SAND SURFACES SMOOTH WHERE CHIPPED PIECES OCCUR. REMOVE PRESENT FINISH TO NATURAL WOOD WHERE REQUIRED TO OBTAIN FINISH SELECTED. CUT OUT AND FILL CRACKS OR OTHER DEFECTS TO MATCH ADJOINING SURFACES.

REMOVE HARDWARE, HARDWARE ACCESSORIES, MACHINED SURFACES, FLATES, LIGHTING FIXTURES, AND SIMILAR ITEMS IN PLACE AND NOT TO BE FINISH-PAINTED, OR PROVIDE SURFACE-APPLIED PROTECTION PRIOR TO SURFACE PREPARATION AND PAINTING OPERATIONS. REMOVE, IF NECESSARY, FOR COMPLETE PAINTING OF ITEMS AND ADJACENT SURFACES. FOLLOWING COMPLETION OF PAINTING OF EACH SPACE OR AREA, REINSTALL REMOVED ITEMS.

CLEAN SURFACES TO BE PAINTED BEFORE APPLYING PAINT OR SURFACE TREATMENTS. REMOVE OIL AND GREASE PRIOR TO MECHANICAL CLEANING. PROGRAM CLEANING AND PAINTING SO THAT CONTAMINANTS FROM CLEANING PROCESS WILL NOT FALL ONTO YET, NEATLY PAINTED SURFACES.

DETERMINE ALKALINITY AND MOISTURE CONTENT OF SURFACES TO BE PAINTED BY PERFORMING APPROPRIATE TESTS. IF SURFACES ARE FOUND TO BE SUFFICIENTLY ALKALINE TO CAUSE BLISTERING AND BURNING OF FINISH PAINT, CORRECT THIS CONDITION BEFORE APPLICATION OF PAINT. DO NOT PAINT OVER SURFACES WHERE MOISTURE CONTENT EXCEEDS THAT PERMITTED IN MANUFACTURER'S PRINTED DIRECTIONS.

**MATERIALS PREPARATION:**

MIX AND PREPARE PAINTING MATERIALS IN ACCORDANCE WITH MANUFACTURER'S DIRECTIONS. STORE MATERIALS NOT IN ACTUAL USE IN TIGHTLY COVERED CONTAINERS. MAINTAIN CONTAINERS USED IN STORAGE, MIXING AND APPLICATION OF PAINT IN A CLEAN CONDITION AND FREE OF FOREIGN MATERIALS AND RESIDUE.

STR MATERIALS BEFORE APPLICATION TO PRODUCE A MIXTURE OF UNIFORM DENSITY, AND STR AS REQUIRED DURING APPLICATION. DO NOT STR SURFACE FILM INTO MATERIAL. REMOVE FILM AND, IF NECESSARY, STRAIN MATERIAL BEFORE USING.

**APPLICATION:**

APPLY PAINT IN ACCORDANCE WITH MANUFACTURER'S DIRECTIONS. USE APPLICATORS AND TECHNIQUES BEST SUITED FOR SUBSTRATE AND TYPE OF MATERIAL BEING APPLIED.

APPLY ADDITIONAL COATS WHEN UNDERCOATS, STAINS, OR OTHER CONDITIONS SHOW THROUGH FINAL COAT OF PAINT. UNTIL PAINT FILM IS OF UNIFORM FINISH COLOR, AND APPEARANCE, GIVE SPECIAL ATTENTION TO INSURE THAT SURFACES INCLUDING EDGES, CORNERS, CREVICES, JELDS, AND EXPOSED FASTENERS RECEIVE A DRY FILM THICKNESS EQUIVALENT TO THAT OF FLAT SURFACES.

PAINT SURFACES BEHIND MOVABLE EQUIPMENT AND FURNITURE SAME AS SIMILAR EXPOSED SURFACES. PAINT SURFACES BEHIND PERMANENTLY-FIXED EQUIPMENT OR FURNITURE WITH PRIME COAT ONLY BEFORE FINAL INSTALLATION OF EQUIPMENT.

PAINT INTERIOR SURFACES OF DUCTS, WHERE VISIBLE THROUGH REGISTERS OR GRILLES, WITH A FLAT, NON-SPECULAR BLACK PAINT.

PAINT BACK SIDES OF ACCESS PANELS, AND REMOVABLE OR HINGED COVERS TO MATCH EXPOSED SURFACES.

SAND LIGHTLY BETWEEN EACH SUCCEEDING ENAMEL OR VARNISH COAT.

OMIT FIRST COAT (PRIMER) ON METAL SURFACES WHICH HAVE BEEN SHOP-PRIMED AND TOUCH-UP PAINTED, UNLESS OTHERWISE INDICATED.

SCHEDULING PAINTING: APPLY FIRST-COAT MATERIAL TO SURFACES THAT HAVE BEEN CLEANED, PRETREATED OR OTHERWISE PREPARED FOR PAINTING AS SOON AS PRACTICABLE AFTER PREPARATION AND BEFORE SUBSEQUENT SURFACE DETERIORATION.

ALLOW SUFFICIENT TIME BETWEEN SUCCESSIVE COATINGS TO PERMIT PROPER DRYING. DO NOT RECOAT UNTIL PAINT HAS DRIED TO SUCH A DEGREE THAT IT DOES NOT DEFORM OR FEEL STICKY UNDER MODERATE THUMB PRESSURE, AND APPLICATION OF ANOTHER COAT OF PAINT DOES NOT CAUSE LIFTING OR LOSS OF ADHESION OF THE UNDERCOAT.

MINIMUM COATING THICKNESS: APPLY MATERIALS AT NOT LESS THAN MFR'S RECOMMENDED SPREADING RATE, TO ESTABLISH A TOTAL DRY FILM THICKNESS AS INDICATED, OR IF NOT INDICATED, AS RECOMMENDED BY COATING MFR.

RE-COAT PRIMED AND SEALED SURFACES WHERE THERE IS EVIDENCE OF SUCTION SPOTS OR UNSEALED AREAS IN FIRST COAT TO ASSURE A FINISH COAT WITH NO BURN-THRU OR OTHER DEFECTS DUE TO INSUFFICIENT SEALING.

COMPLETED WORK: MATCH APPROVED SAMPLES FOR COLOR, TEXTURE AND COVERAGE. REMOVE, REFINISH OR REPAINT WORK NOT IN COMPLIANCE WITH SPECIFIED REQUIREMENTS.

CLEAN-UP: DURING PROGRESS OF WORK REMOVE FROM SITE DISCARDED PAINT MATERIALS, RUBBISH, CANS AND RAGS AT END OF EACH WORK DAY.

UPON COMPLETION OF PAINTING WORK, CLEAN WINDOW GLASS AND OTHER PAINT-SPATTERED SURFACES. REMOVE SPATTERED PAINT BY PROPER METHODS OF WASHING AND SCRAPPING, USING CARE NOT TO SCRATCH OR OTHERWISE DAMAGE FINISHED SURFACES.

PROTECTION: PROTECT WORK OF OTHER TRADES (WHETHER TO BE PAINTED OR NOT, AGAINST DAMAGE BY PAINTING AND FINISHING WORK. CORRECT ANY DAMAGE BY CLEANING, REPAIRING OR REPLACING AND REPAINTING, AS ACCEPTABLE TO ARCHITECT. PROVIDE 'NET PAINT' SIGNS AS REQUIRED TO PROTECT NEATLY-PAINTED FINISHES. REMOVE TEMPORARY UNWRAPINGS PROVIDED BY OTHERS FOR PROTECTION OF THEIR WORK, AFTER COMPLETION OF PAINTING OPERATIONS.

AT THE COMPLETION OF WORK OF OTHER TRADES, TOUCH-UP AND RESTORE ALL DAMAGED OR DEFACED PAINTED SURFACES.

## GYPSUM BOARD

GYPSUM WALL BOARD ASTM C36, OF TYPES, EDGE CONFIGURATION AND THICKNESS INDICATED, AND OF MAXIMUM LENGTHS AVAILABLE TO MINIMIZE END-TO-END BUILT JOINTS.

TYPE: REGULAR, EXCEPT WHERE OTHERWISE INDICATED.  
TYPE: FOIL-BACKED WHERE INDICATED.  
TYPE: TYPE X FOR FIRE-RESISTANT RATED ASSEMBLIES AND WHERE INDICATED.

EDGES: TAPERED  
THICKNESS: AS INDICATED IN TYPICAL WALL SECTIONS OR DETAILS.

PROVIDE MFR'S STANDARD TRIM ACCESSORIES OF TYPES INDICATED, INCLUDING CORNER BEADS, J-STOPS, AND CABING BEADS FOR DRYWALL WORK, FORMED OF GALVANIZED STEEL UNLESS OTHERWISE INDICATED, OR AS REQUIRED.

GYPSUM BOARD SCREWS SHALL BE SIMILAR TO USG TYPE 9 BUGLE HEAD SCREWS FOR ATTACHING GYPSUM BOARD TO METAL FRAMING AND TYPE II BUGLE HEAD SCREWS FOR ATTACHING GYPSUM BOARD TO WOOD FRAMING. LENGTH OF SCREWS SUFFICIENT TO PENETRATE FRAMING MEMBER OR STUD NOT LESS THAN 3/4".

INSTALL EXPOSED GYPSUM BOARD WITH FACE SIDE OUT. DO NOT INSTALL IMPERFECT, DAMAGED OR DAMP BOARDS, BUTT BOARDS TOGETHER FOR A LIGHT CONTACT AT EDGES AND ENDS WITH NOT MORE THAN 1/16" OPEN SPACE BETWEEN BOARDS. DO NOT FORCE INTO PLACE.

LOCATE EITHER EDGE OR END JOINTS OVER SUPPORTS, EXCEPT IN HORIZONTAL APPLICATIONS OR WHERE INTERMEDIATE SUPPORTS OR GYPSUM BOARD CONT-BLOCKING IS PROVIDED BEHIND END JOINTS. POSITION BOARDS SO THAT LIKE EDGES ADJUT. TAPERED EDGES AGAINST TAPERED EDGES AND HILL-CUT OR FIELD-CUT ENDS AGAINST HILL-CUT OR FIELD-CUT ENDS. DO NOT FLANGE TAPERED EDGES AGAINST CUT EDGES OR ENDS. STAGGER VERTICAL JOINTS OVER DIFFERENT STUDS ON OPPOSITE SIDES OF PARTITIONS.

FASTEN GYPSUM BOARD WITH SCREWS 8" O. C. AT ALL STUDS AND/OR FRAMING MEMBERS.

APPLY GYPSUM BOARD TAPE AT JOINTS BETWEEN GYPSUM BOARDS, EXCEPT WHERE TRIM ACCESSORIES ARE INDICATED.

APPLY JOINT COMPOUND IN 3 COATS (NOT INCLUDING PREFILL OF OPENINGS IN BASE), AND SAND BETWEEN LAST 2 COATS AND AFTER LAST COAT.

## SUSPENDED CEILING

PROVIDE ALL CUT PANELS AND CUT GRID SYSTEMS AS REQUIRED BY CEILING LAYOUTS, AS REQUIRED BY JOB-SITE DIMENSIONS, AND AS MAY BE NECESSARY BY JOB CONDITIONS.

PROVIDE ALL OPENINGS, HOLES, AND CUT OUTS IN TILE PANELS AS REQUIRED BY ALL WORK OF OTHER TRADES.

GRID SYSTEMS SHALL BE SUSPENDED FROM ROOF OR FLOOR FRAMING AND SHALL BE COMPLETE WITH ALL ITEMS AND ACCESSORIES TO PERMANENTLY HANG AND SUPPORT THE CEILING, THE LIGHTING FIXTURES, AND THE HEATING SYSTEM GRILLES, DIFFUSERS, & LOUVERS. HANGING WIRES SHALL BE MINIMUM 1/8" DIA. STEEL FOR ALL STEEL. GRID SYSTEMS AT MAXIMUM 48" O.C. ALONG MAIN RUNNERS AND MINIMUM 1/2" DIAMETER ALUMINUM HANGING WIRES FOR ALUMINUM GRID SYSTEMS. NO CRIMPING OF WIRES WILL BE ACCEPTED.

IN ADDITION TO HANGING WIRES SPECIFIED ABOVE, INSTALL ONE HANGING WIRE AT EACH CORNER OF EACH RECESSED LIGHTING FIXTURE AND AT EACH CORNER OF EACH HEATING SYSTEM GRILLE, DIFFUSER, OR LOUVER.

INSTALL WALL ANGLES AT INTERSECTION OF SUSPENDED CEILING WITH ALL VERTICAL SURFACES AND FASTEN THERE TO UNLESS SHOWN OTHERWISE ON THE DRAWINGS.

## DESIGN BUILD MECHANICAL

- ALL HVAC WORK SHALL BE DESIGN BUILD CONCEPT USING ALL DRAWINGS AND SPECIFICATIONS AS A GUIDE WHERE APPLICABLE.
- IN GENERAL, THE WORK SHALL INCLUDE ALL LABOR, MATERIALS, EQUIPMENT AND SERVICES NECESSARY TO PROVIDE THE HVAC WORK AND ALL ADDITIONAL WORK SHOWN ON THE DRAWINGS AND SPECIFIED HEREINAFTER.
- SECURE ALL PERMITS AND LICENSES APPLICABLE TO THIS DIVISION. PAY ALL FEES INCIDENT THERETO. COMPLY WITH LOCAL, STATE AND NATIONAL ORDINANCES, LAWS, REGULATIONS AND CODES.
- THE HVAC SYSTEMS SHALL BE ENGINEERED WITH DRAWINGS PREPARED BY A REGISTERED ENGINEER OR STATE OF WISCONSIN REGISTERED DESIGNER.
- THE SUCCESSFUL CONTRACTOR SHALL PREPARE DESIGN DRAWINGS FOR DISTRIBUTION TO STATE AND LOCAL REVIEW AUTHORITIES, AS WELL AS FOR OWNER AND ARCHITECT REVIEW AFTER REVIEW DESIGN DRAWINGS SHALL BE REVISED AND SHALL THEN BECOME DESIGN DOCUMENTS TO BE USED FOR CONSTRUCTION.
- REMODEL ANY HVAC SYSTEMS AS REQ'D FOR INSTALLATION OF NEW SOFFIT.

## DESIGN BUILD ELECTRICAL

- ALL ELECTRICAL WORK SHALL BE DESIGN BUILD CONCEPT USING ALL DRAWINGS AND SPECIFICATIONS AS A GUIDE WHERE APPLICABLE.
- IN GENERAL, THE WORK SHALL INCLUDE ALL LABOR, MATERIALS, EQUIPMENT AND SERVICES NECESSARY TO PROVIDE THE ELECTRICAL WORK AND ALL ADDITIONAL WORK SHOWN ON THE DRAWINGS AND SPECIFIED HEREINAFTER.
- SECURE ALL PERMITS AND LICENSES APPLICABLE TO THIS DIVISION. PAY ALL FEES INCIDENT THERETO. COMPLY WITH LOCAL, STATE AND NATIONAL ORDINANCES, LAWS, REGULATIONS AND CODES.
- THE SUCCESSFUL CONTRACTOR SHALL PREPARE DESIGN DRAWINGS FOR DISTRIBUTION TO STATE AND LOCAL REVIEW AUTHORITIES, AS WELL AS FOR OWNER AND ARCHITECT REVIEW AFTER REVIEW DESIGN DRAWINGS SHALL BE REVISED AND SHALL THEN BECOME DESIGN DOCUMENTS TO BE USED FOR CONSTRUCTION.



920 GOULD STREET ■ RACINE, WI 53402 ■ 262.634.5565  
INFO@RUDIEFRANK.COM

## PROJECT INFO

MAJOR OCCUPANCY TYPE: A-3 Courtroom

WORK AREA :  
Area A 1,730 s.f.  
Area B 2,318 s.f.

SPRINKLER PROTECTION: None  
CONSTRUCTION CLASS: Type IIB  
ALTERATION LEVEL: 2

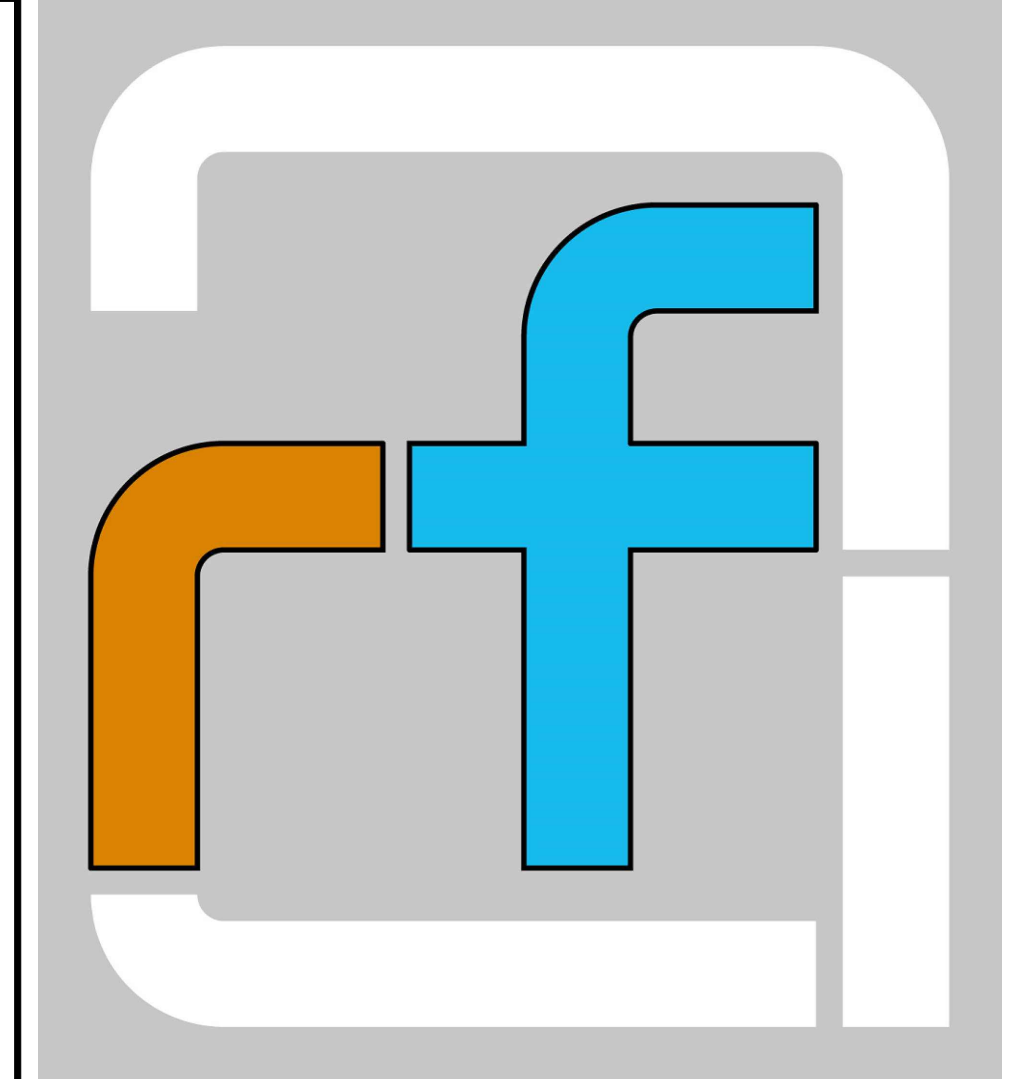

## REVISIONS

01-20-20 - ISSUED FOR BUDGETING  
02-26-21 - ADDENDUM #1  
03-30-21 - ISSUED FOR RE-BID

## INDEX OF DRAWINGS

- A1 — TITLE SHEET  
A2 — DEMOLITION PLAN  
A3 — REMODELED FLOOR PLAN ROOM FINISH SCHEDULE  
A4 — REFLECTED CEILING PLAN CABINET ELEVATIONS  
A5 — RAISED FLOOR PLAN

## DATE

MAR. 30, 2021

## PROJECT NO.

21-19

## SHEET NO.

A1

LAW ENFORCEMENT CENTER - COURTROOM RENOVATIONS

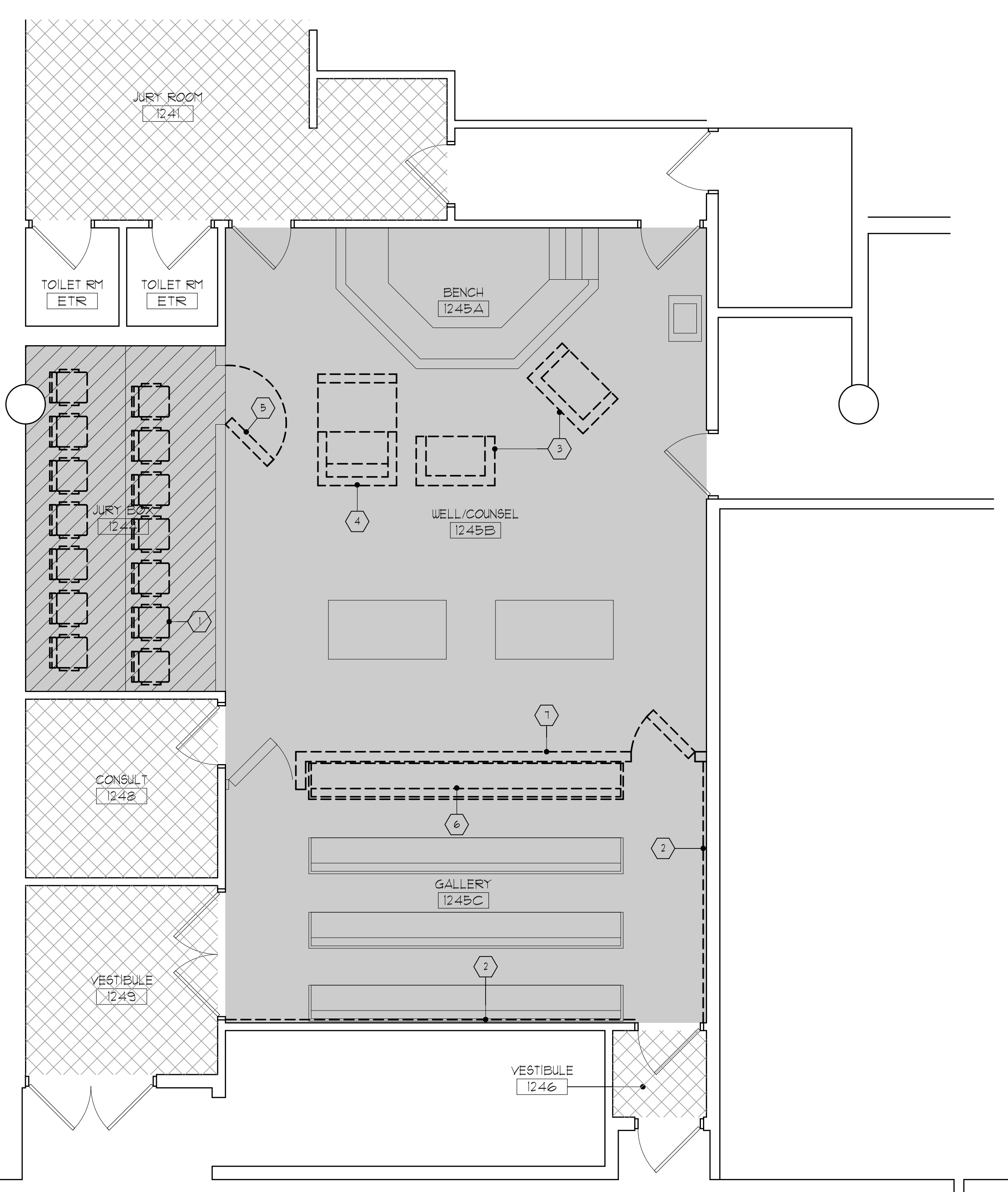
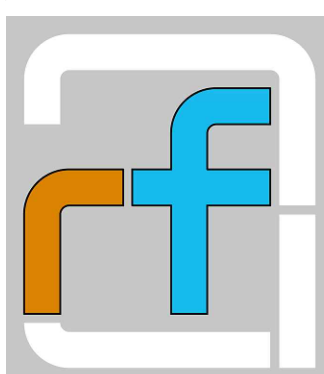

**KEYED DEMOLITION NOTES (this sheet)**

- REMOVE FLOORING, BASE, WALL COVERINGS AND SUSPENDED CEILING FROM THIS AREA AS REQ'D FOR NEW CONSTRUCTION. SEE ROOM FINISH SCHEDULE.
- ▨ REMOVE FLOOR SUBSTRATE AS REQ'D FOR INSTALLATION OF NEW PLYWOOD FLOOR. SEE ALSO REMODELED FLOOR PLAN.
- ▩ REMOVE FLOORING AND BASE FROM THIS AREA AS REQ'D FOR NEW CONSTRUCTION. SEE ROOM FINISH SCHEDULE.
- ① REMOVE FLOOR MOUNTED CHAIRS AS REQ'D FOR NEW CONSTRUCTION. SALVAGE FOR RE-INSTALLATION.
- ② REMOVE EXISTING FRP AND CHAIR RAIL AS REQ'D FOR NEW CONSTRUCTION. SALVAGE CHAIR RAIL FOR RE-USE.
- ③ REMOVE WORKSTATIONS AS REQ'D. COORDINATE W/ OWNER.
- ④ EXISTING WITNESS STAND TO BE SALVAGED FOR REMODELING. SEE REMODELED PLAN.
- ⑤ REMOVE DOOR AND HARDWARE AS REQ'D.
- ⑥ EXISTING FEU TO BE REMOVED AND RELOCATED TO LOCATION AS DETERMINED BY OWNER.
- ⑦ EXISTING DWARF WALL TO BE REMOVED AS REQUIRED TO REFINISH AND RELOCATE. SEE ALSO REMODELED FLOOR PLAN.

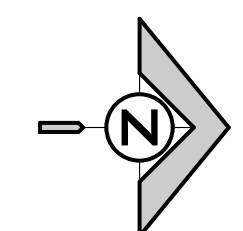

**EXISTING FIRST FLOOR / DEMOLITION PLAN**

SCALE : 1/4" = 1'-0"

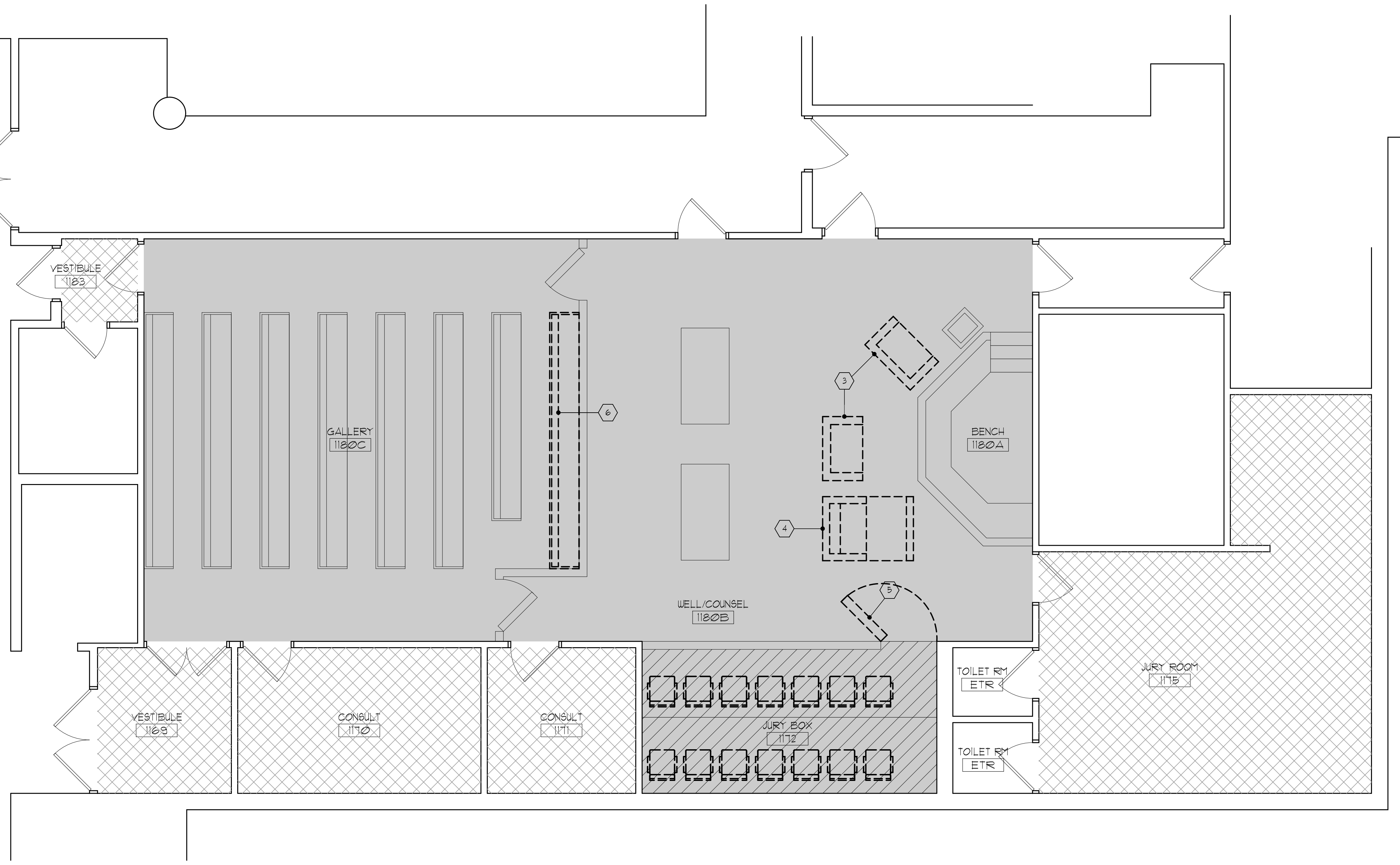

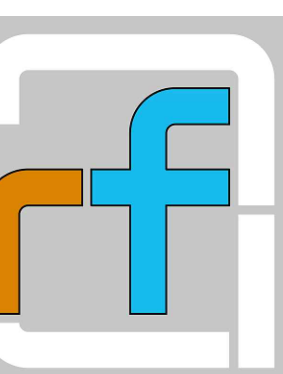

### ROOM FINISH SCHEDULE

NO.	ROOM NAME	FLOOR	BASE	WALLS				CEILING	MILLWORK		REMARKS
				NORTH	SOUTH	EAST	WEST		COUNTERTOP	FACES	
116B	VESTIBULE	LUXURY VINYL TILE (LVT-1)	VNVL (VB-1)	PAINTED GYPSUM BOARD	PAINTED GYPSUM BOARD	PAINTED GYPSUM BOARD	PAINTED GYPSUM BOARD	ETR			
1170	CONSULT	LUXURY VINYL TILE (LVT-1)	VNVL (VB-1)	PAINTED GYPSUM BOARD	PAINTED GYPSUM BOARD	PAINTED GYPSUM BOARD	PAINTED GYPSUM BOARD	ETR			
1171	CONSULT	LUXURY VINYL TILE (LVT-1)	VNVL (VB-1)	PAINTED GYPSUM BOARD	PAINTED GYPSUM BOARD	PAINTED GYPSUM BOARD	PAINTED GYPSUM BOARD	ETR			
1172	JURY BOX	CARPET (C-1)	VNVL (VB-1)	PAINTED GYPSUM BOARD	PAINTED GYPSUM BOARD	PAINTED GYPSUM BOARD	---	ACOUSTICAL TILE (ACT-1) AT 9'-0" AFF. MAIN FLR.			NEW SUBFLOOR IN THIS AREA
117B	JURY ROOM	LUXURY VINYL TILE (LVT-1)	VNVL (VB-1)	PAINTED GYPSUM BOARD	PAINTED GYPSUM BOARD	PAINTED GYPSUM BOARD	PAINTED GYPSUM BOARD	ETR			
1240A	BENCH	CARPET (C-1) INCLUDING STAIRS	VNVL (VB-1)	PAINTED GYPSUM BOARD	---	---	---	ACOUSTICAL TILE (ACT-1) AT 11'-0" AFF. MAIN FLR.			
1240B	WELL / COUNSEL	CARPET (C-1)	VNVL (VB-1)	PAINTED GYPSUM BOARD	---	PAINTED GYPSUM BOARD	PAINTED GYPSUM BOARD	ACOUSTICAL TILE (ACT-1) AT 11'-0" AFF. MAIN FLR.			NEW RAISED SUBFLOOR IN THIS AREA. SEE RAISED FLOOR PLAN.
1240C	GALLERY	LUXURY VINYL TILE (LVT-1)	VNVL (VB-1)	---	FRP TO 36' AFF. / PAINT ABOVE	FRP TO 36' AFF. / PAINT ABOVE	FRP TO 36' AFF. / PAINT ABOVE	ACOUSTICAL TILE (ACT-1) AT 9'-0" AFF. MAIN FLR.			
1183	VESTIBULE	LUXURY VINYL TILE (LVT-1)	VNVL (VB-1)	PAINTED GYPSUM BOARD	PAINTED GYPSUM BOARD	PAINTED GYPSUM BOARD	PAINTED GYPSUM BOARD	ETR			
1241	JURY ROOM	LUXURY VINYL TILE (LVT-1)	VNVL (VB-1)	PAINTED GYPSUM BOARD	PAINTED GYPSUM BOARD	PAINTED GYPSUM BOARD	PAINTED GYPSUM BOARD	ETR			
1244	JURY BOX	CARPET (C-1)	VNVL (VB-1)	---	PAINTED GYPSUM BOARD	PAINTED GYPSUM BOARD	PAINTED GYPSUM BOARD	ACOUSTICAL TILE (ACT-1) AT 9'-0" AFF. MAIN FLR.			NEW SUBFLOOR IN THIS AREA
1245A	BENCH	CARPET (C-1) INCLUDING STAIRS	VNVL (VB-1)	---	---	---	PAINTED GYPSUM BOARD	ACOUSTICAL TILE (ACT-1) AT 11'-0" AFF. MAIN FLR.			
1245B	WELL / COUNSEL	CARPET (C-1)	VNVL (VB-1)	PAINTED GYPSUM BOARD	PAINTED GYPSUM BOARD	---	PAINTED GYPSUM BOARD	ACOUSTICAL TILE (ACT-1) AT 11'-0" AFF. MAIN FLR.			NEW RAISED SUBFLOOR IN THIS AREA. SEE RAISED FLOOR PLAN.
1245C	GALLERY	LUXURY VINYL TILE (LVT-1)	VNVL (VB-1)	FRP TO 36' AFF. / PAINT ABOVE	FRP TO 36' AFF. / PAINT ABOVE	FRP TO 36' AFF. / PAINT ABOVE	---	ACOUSTICAL TILE (ACT-1) AT 9'-0" AFF. MAIN FLR.			NEW RAISED SUBFLOOR IN THIS AREA. SEE RAISED FLOOR PLAN.
1246	VESTIBULE	LUXURY VINYL TILE (LVT-1)	VNVL (VB-1)	PAINTED GYPSUM BOARD	PAINTED GYPSUM BOARD	PAINTED GYPSUM BOARD	PAINTED GYPSUM BOARD	ETR			
1248	CONSULT	LUXURY VINYL TILE (LVT-1)	VNVL (VB-1)	PAINTED GYPSUM BOARD	PAINTED GYPSUM BOARD	PAINTED GYPSUM BOARD	PAINTED GYPSUM BOARD	ETR			
1249	VESTIBULE	LUXURY VINYL TILE (LVT-1)	VNVL (VB-1)	PAINTED GYPSUM BOARD	PAINTED GYPSUM BOARD	PAINTED GYPSUM BOARD	PAINTED GYPSUM BOARD	ETR			

### ROOM FINISH MATERIAL SELECTIONS

- C-1 ..... MATERIAL ALLOWANCE OF 135 PER SQ. YD. CARPET TILE PATTERN AS SELECTED
- ACT-1 ..... AR'STRONG 'CIRRUS' 24x24 - WHITE ANGLED TEGULAR GRID 9/16 GRID - WHITE
- LVT-1 ..... LUXURY VINYL TILE SHAW 'NEW MARKET 200' 6x48 COLOR: BRECKENRIDGE 1007122
- P-1 ..... PAINT BENJAMIN MOORE COLOR - NAVALO WHITE 'OC-95
- FRP ..... FIBRE-REINFORCED PLASTIC MANUFACTURER - CRANE COMPOSITES 'GLASBORD' EMBOSSED TEXTURE W/ MATCHING MOLDINGS AND TRIM COLOR AS SELECTED
- VB-1 ..... 4" HIGH COVERED VINYL WALL BASE MANUFACTURER - TARKETT COLOR - TOAST

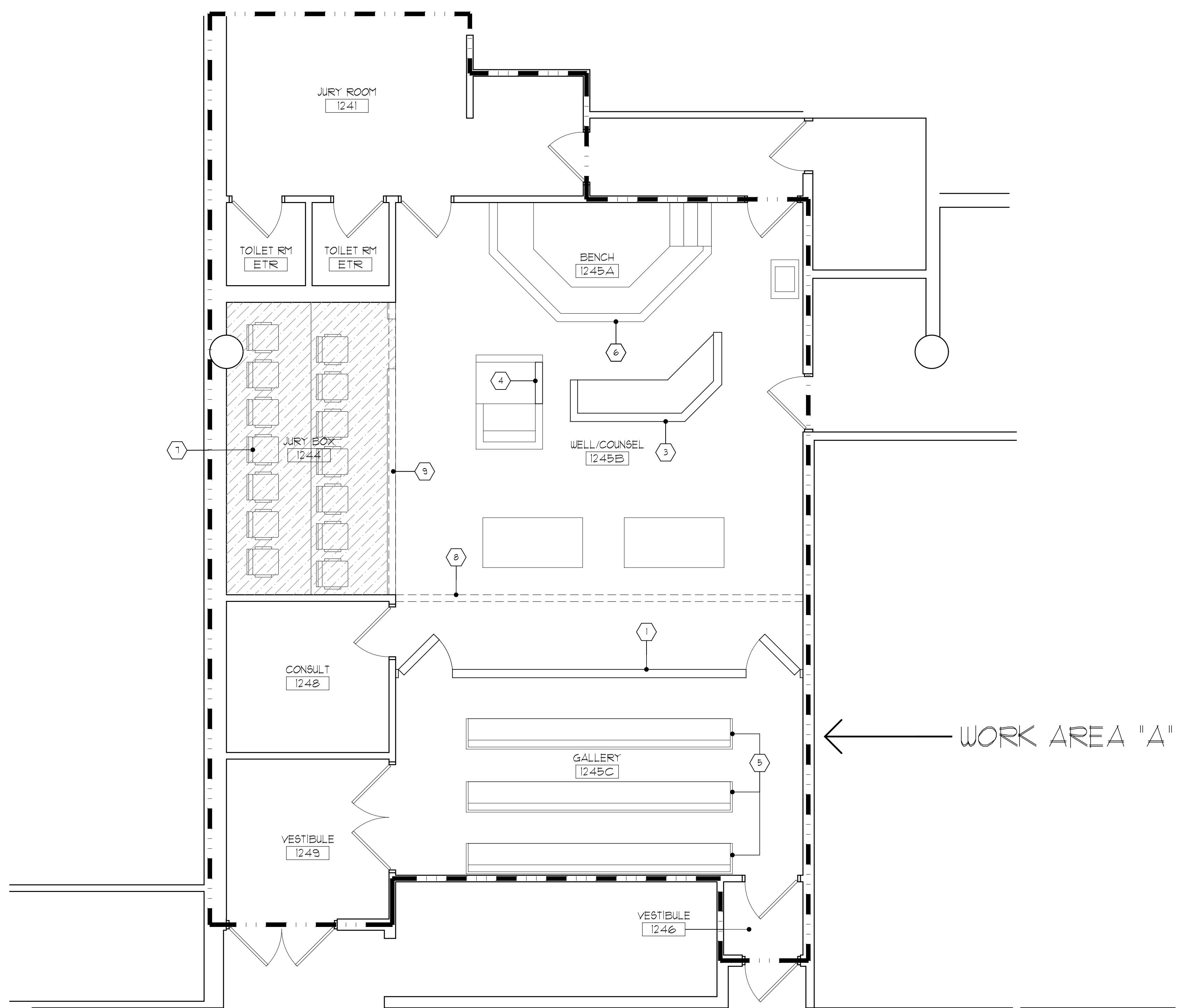

← WORK AREA "A"

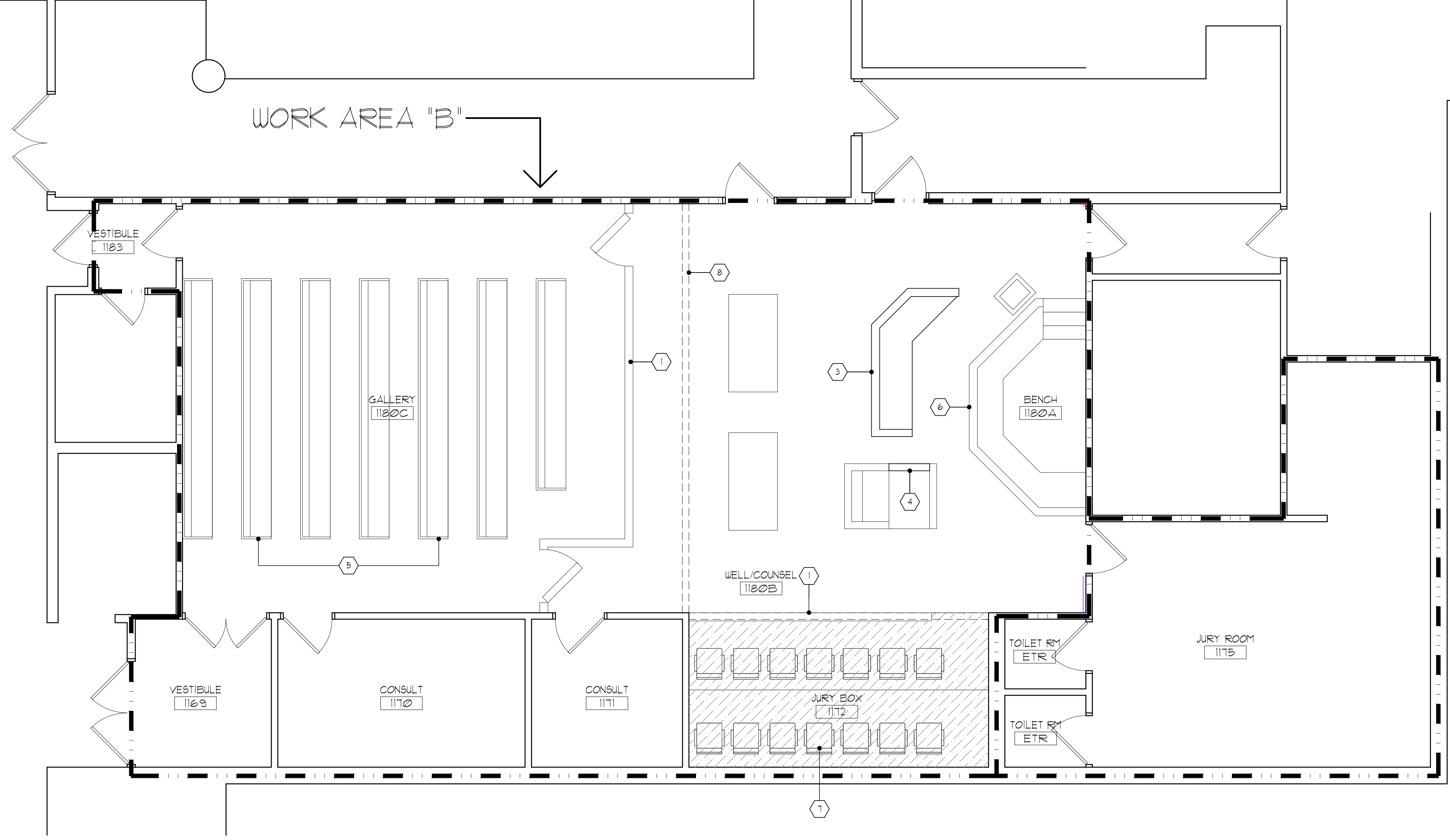

↓ WORK AREA "B"

### KEYED REMODEL NOTES (this sheet)

- 1 NEW 3/4" THICK PLYWOOD TO BE INSTALLED OVER EXISTING FLOOR FRAMING AS REQ'D.
- 2 EXISTING DWARF WALL TO BE RELOCATED TO LOCATION IN LINE W/ EXISTING GATE ON SOUTH SIDE. REMODEL WALL AS REQ'D. WOOD TO BE FILLED, SANDED SMOOTH AND RE-STAINED AND VARNISHED TO BE UNIFORM ACROSS ALL SURFACES. STAIN COLOR AS SELECTED.
- 3 NOT USED
- 4 NEW MILLWORK WORKSTATION. SEE ELEVATIONS ON SHEET A4.
- 5 REMODEL MILLWORK TO EXTEND SIDE WALL TO REAR OF EXISTING WITNESS STAND.
- 6 EXISTING FIBS TO BE REFINISHED. WOOD TO BE FILLED, SANDED SMOOTH AND RE-STAINED AND VARNISHED TO BE UNIFORM ACROSS ALL SURFACES. STAIN COLOR AS SELECTED.
- 7 EXISTING JUDGE'S DESK TO BE REFINISHED. WOOD TO BE FILLED, SANDED SMOOTH AND RE-STAINED AND VARNISHED TO BE UNIFORM ACROSS ALL SURFACES. STAIN COLOR AS SELECTED.
- 8 NEW FLOOR-MOUNTED JURY CHAIRS. PURCHASED BY OWNER, INSTALLED BY GENERAL CONTRACTOR.
- 9 NEW SOFFIT CONSTRUCTED OF 1/2" GYPSUM BD. ON BOTH SIDES OF 3 1/2" DEEP METAL STUDS AT 16" O.C. HANG FROM STRUCTURE ABOVE. RUN GYPSUM BD TO 6" ABOVE FINISH CEILING HEIGHT. BOT. OF SOFFIT AT 8'-10" AFF.
- 10 DWARF WALL TO BE REFINISHED. WOOD TO BE FILLED, SANDED SMOOTH AND RE-STAINED AND VARNISHED TO BE UNIFORM ACROSS ALL SURFACES. STAIN COLOR AS SELECTED.

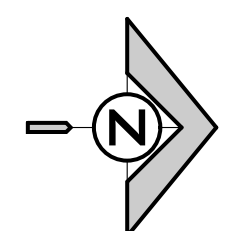

### REMODELED FIRST FLOOR PLAN

SCALE: 1/4" = 1'-0"

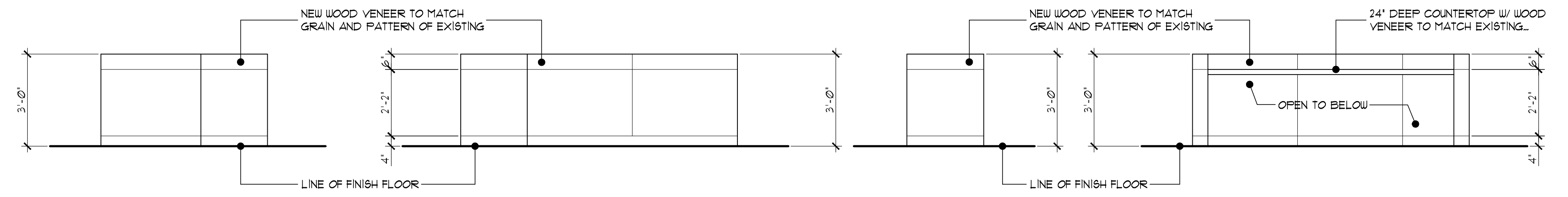
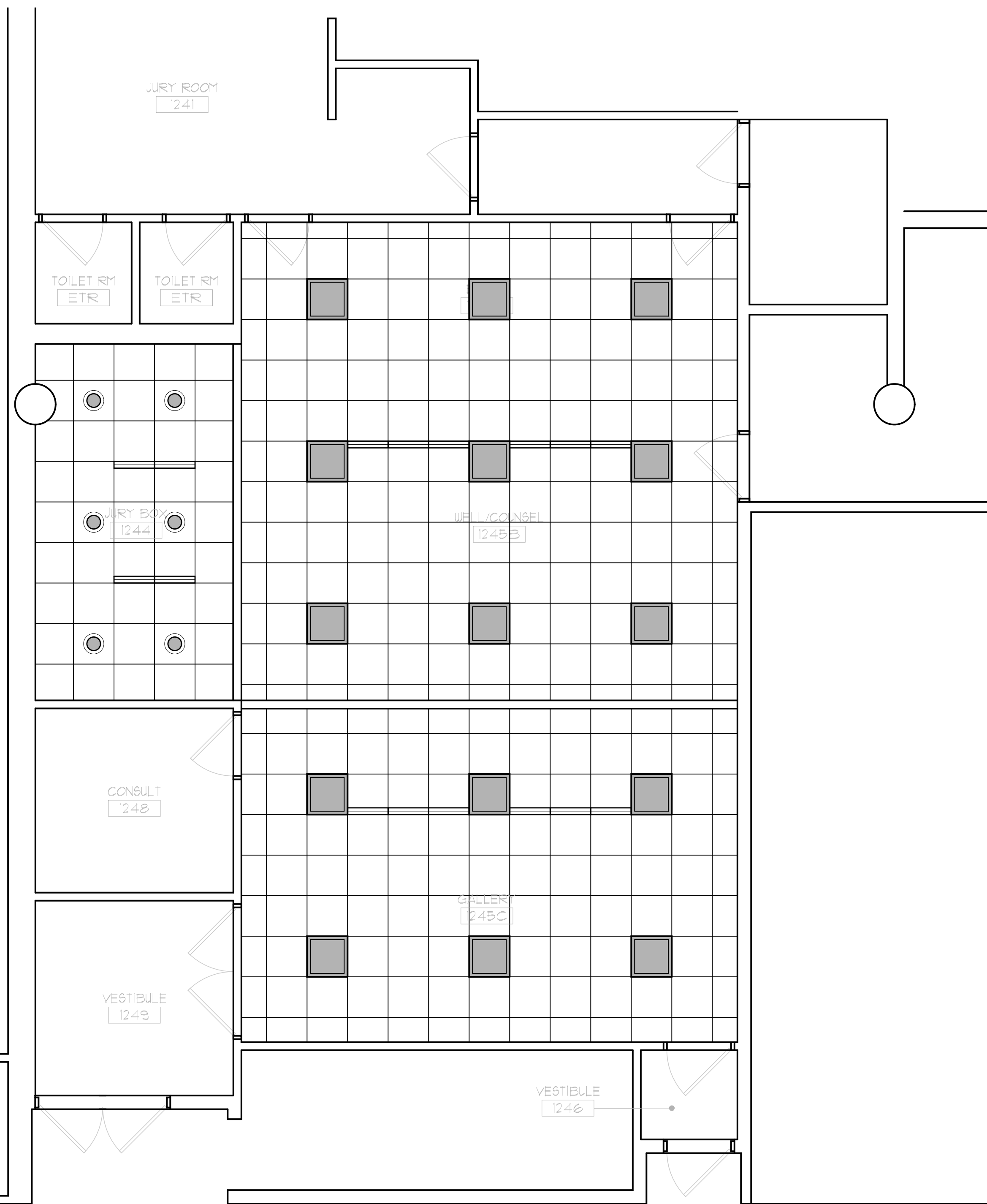

**ELEVATIONS of COURT CLERK WORKSTATION in COURTROOM 1180**  
 SCALE: 3/8" = 1'-0"  
 WORKSTATION IN COURTROOM 1245 SIMILAR IN MIRROR

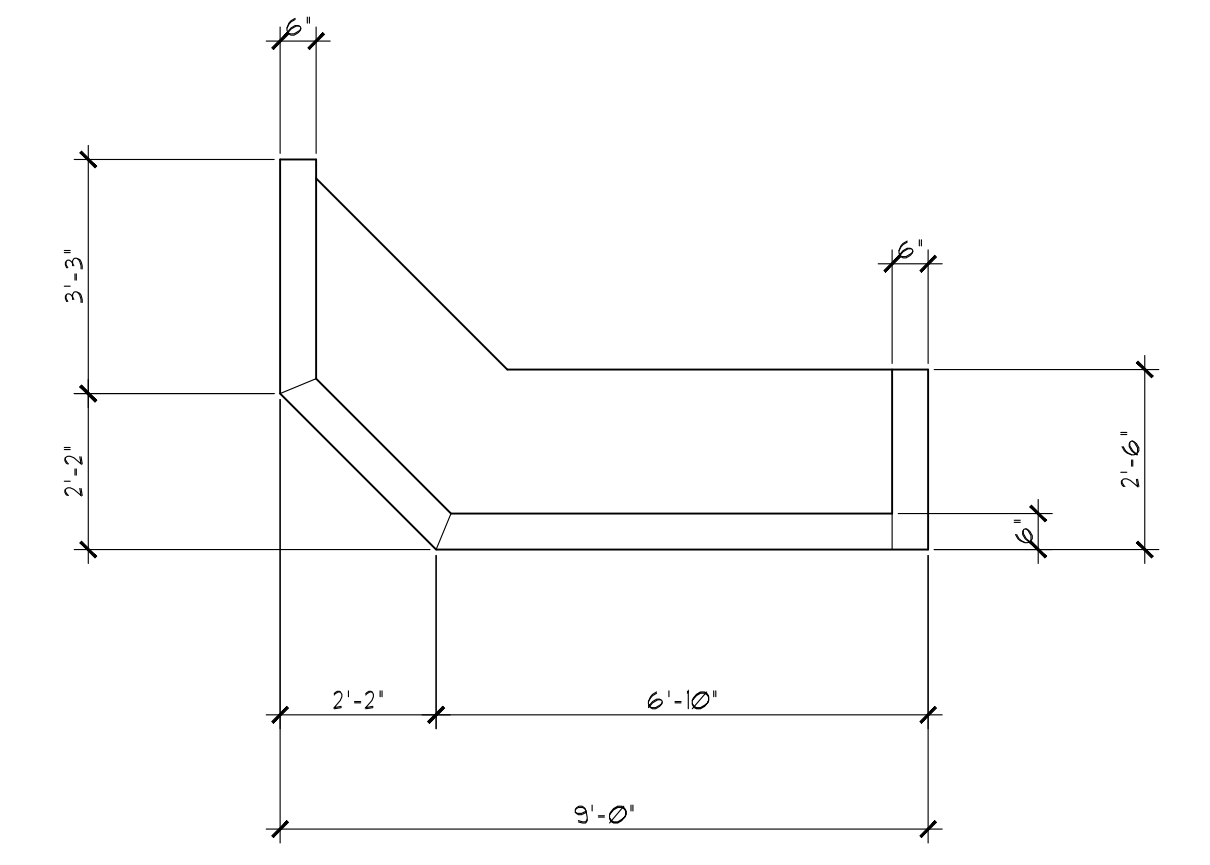

**PLAN of WORKSTATION**  
 SCALE: 3/8" = 1'-0"

**REFLECTED CEILING LEGEND**

-  NEW 24x24 LED DROP-IN LIGHT FIXTURE  
4000K COLOR TEMPERATURE
-  NEW 6\"/>

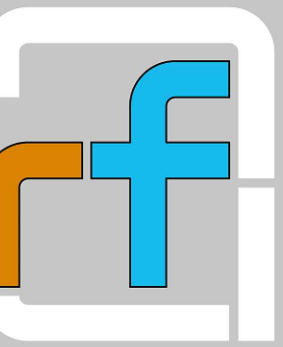
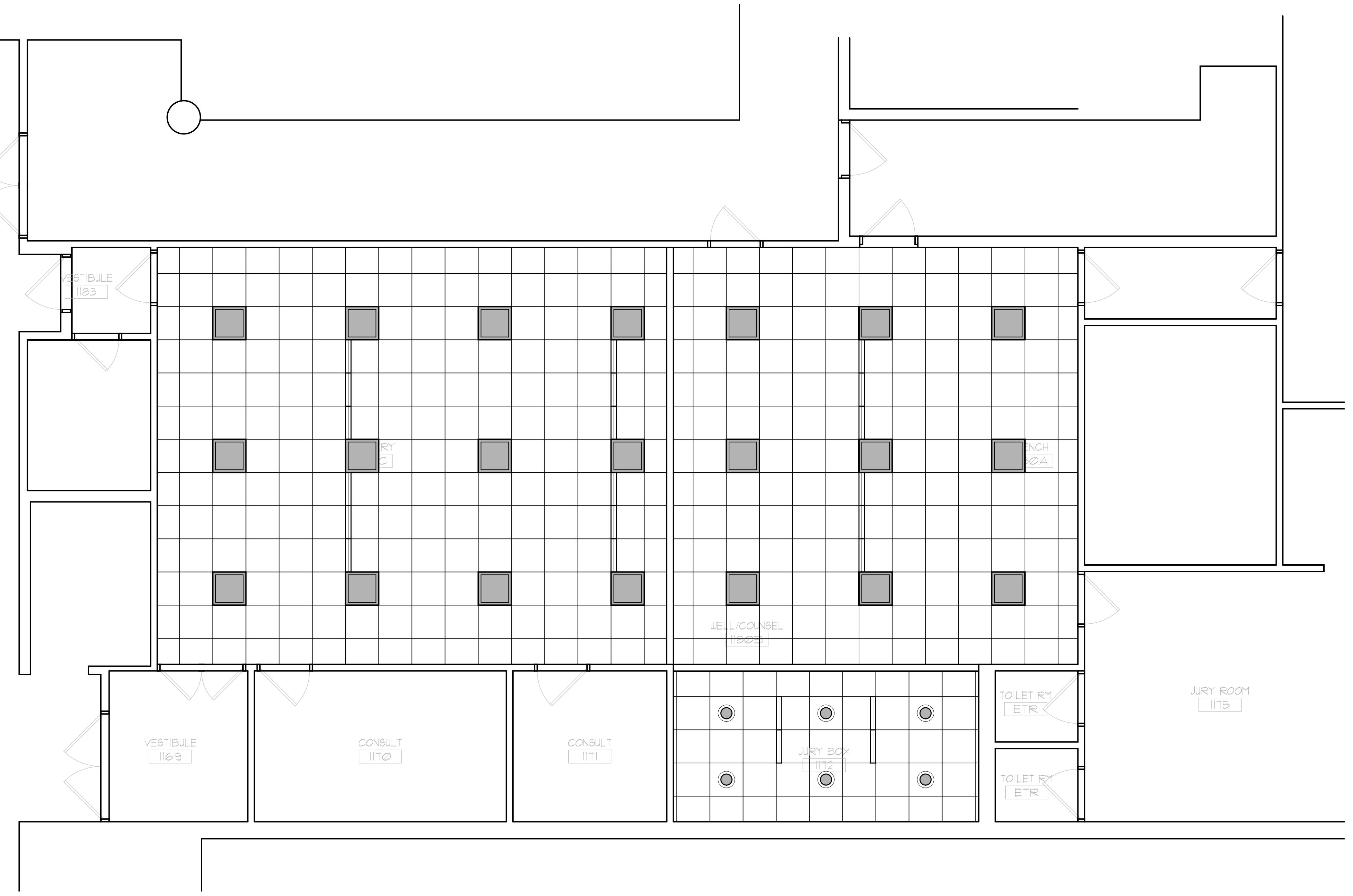
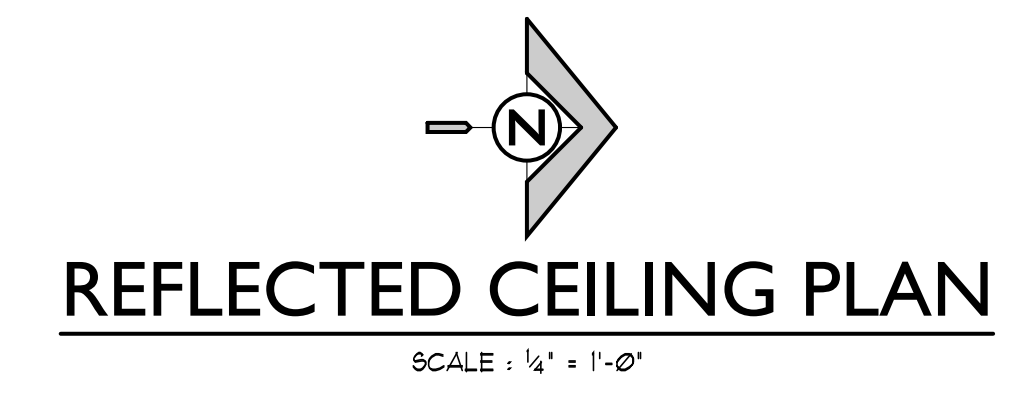

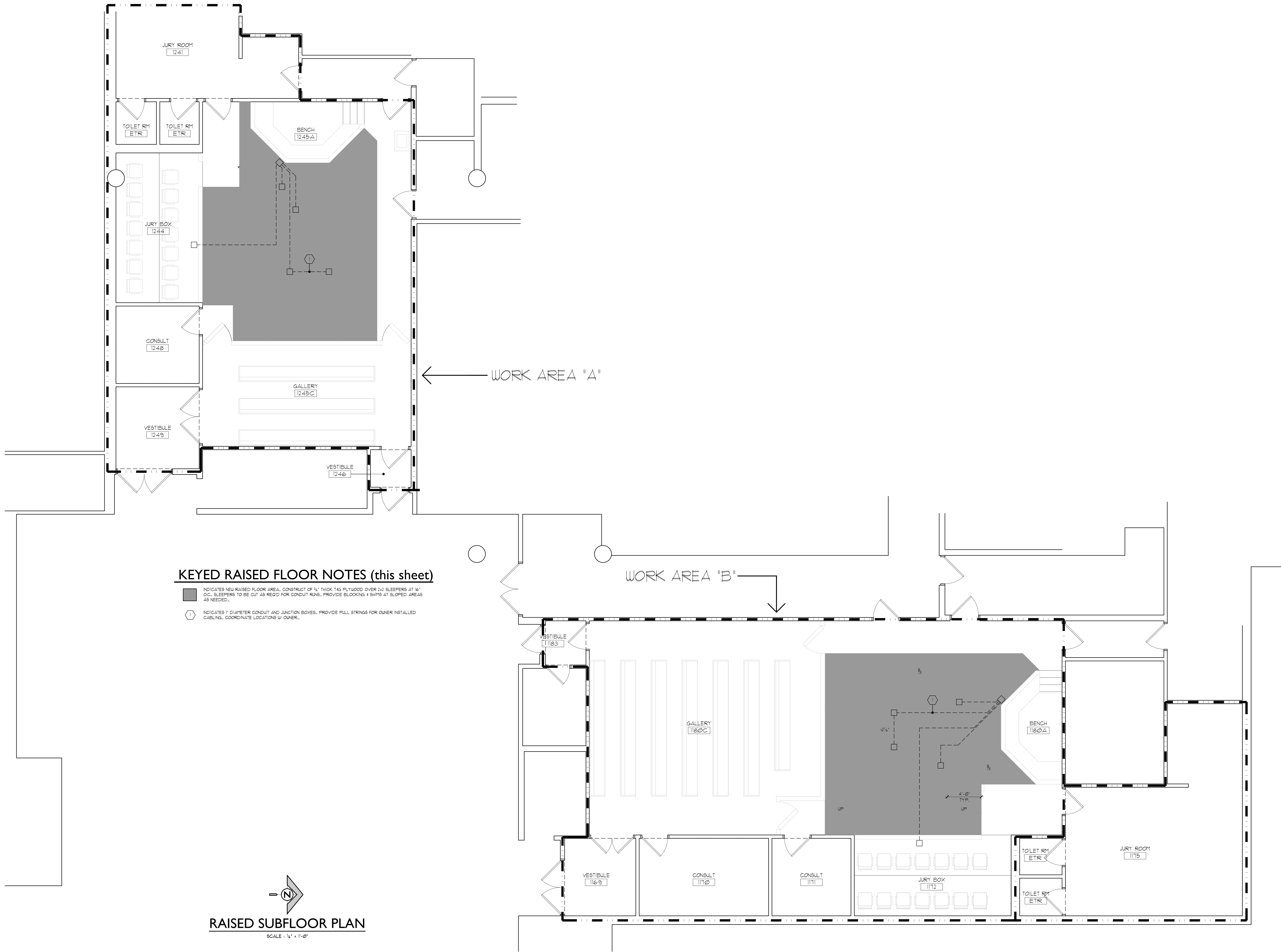

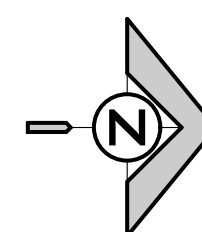
  
**RAISED SUBFLOOR PLAN**  
 SCALE: 1/4" = 1'-0"

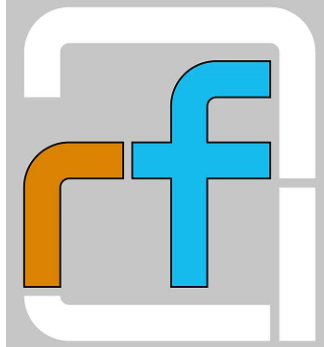

REVISIONS