

LEGEND

- Area to Re-Zone/Project Boundary
- Existing Structure
- Existing Vegetation
- Existing Wetland
- Streets and Haul Roads
- ~ Topographic Contour Lines
- Operations Area
- Mineral Extraction Area
- Mineral Extraction Sequencing
- ↖ Direction of stripping and topsoil replacement

2ft Topographic contour information, parcel data and wetland data download from Racine County GIS.

0 200 400

- Operations Notes:**
- Traffic from the site will use the existing farm road south to Northwest Circle and STH 83
 - Stripped topsoil and overburden to be kept separate and stored in temporary stockpiles until needed for reclamation.
 - Mineral extraction will take place in phases, with approximately 20 - 25 acres open at a time. Open acreage not including stockpile and operations area.
 - Phasing subject to change with variability in mineral deposit and operational requirements.
 - Stockpiled overburden and topsoil will be used to reclaim the previously mined areas.
 - Drainage and run-off within the pit area will be internal and allowed to dissipate through the floor. Run-off from outside the pit area will follow the existing natural drainage patterns.
 - Temporary operations pond may be constructed during mineral extraction operations.
 - Operation ponds will be filled-in with earth materials upon completion of mineral extraction.
 - Total Length of Road Improvements:
Northwest Circle: 1,600 ft
Internal Haul Route: 2,000 ft

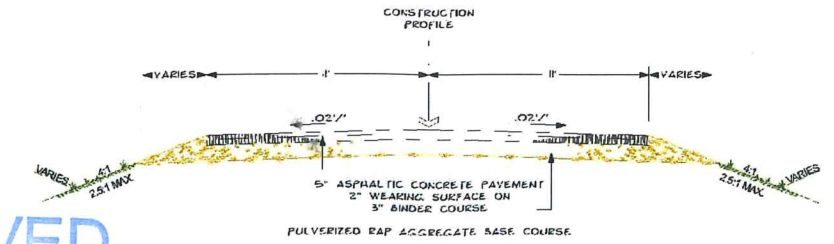

TYPICAL PAVING SECTION @ HAUL ROAD

RECEIVED

JAN 28 2021

RACINE COUNTY

REVISED 8/8/2017

HAUL ROAD REVISION

OPERATIONS PLAN

Payne & Dolan, Inc.
N3 W23660 Badinger Rd
Waukesha, WI 53187

NOTES:

PROJECT:
Nonmetallic Mineral Extraction and Reclamation
Clearwater Acres LLP
Town of Waterford, Racine County, Wisconsin

BY	DATE	REVISION

DATE: 8/8/2017
DRAWN BY: EJC
DRAWING #:
SCALE:

3



Racine County

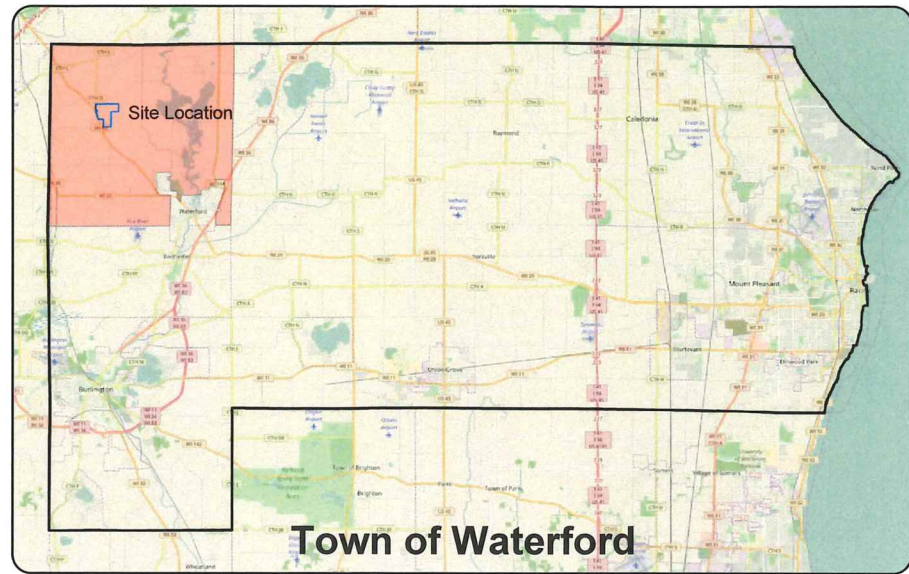

Town of Waterford

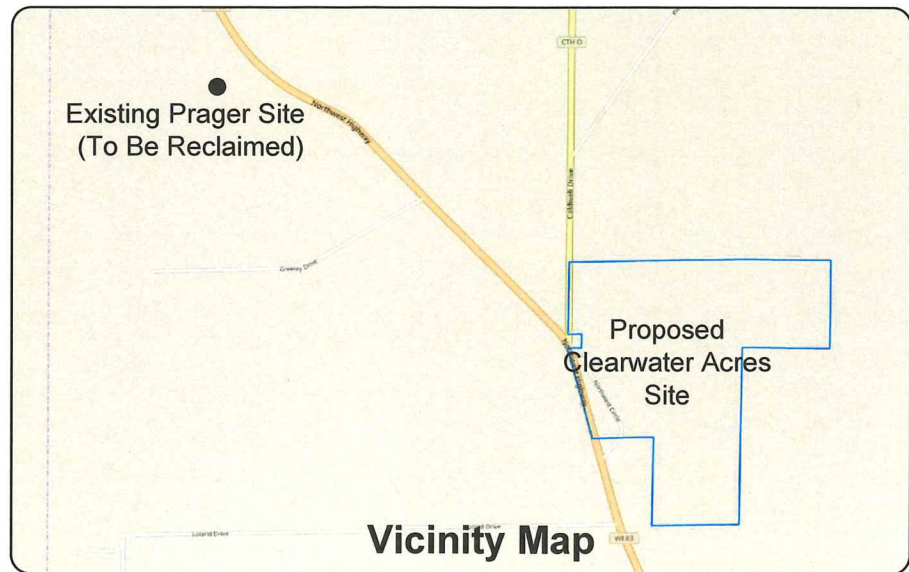

Vicinity Map

Proposed Site Development for Non-metallic Mineral Extraction and Reclamation

Clearwater Acres LLP Property, Town of Waterford, Racine County



Requested Re-zone
and C.U.P. Area

INDEX OF EXHIBITS

1. Title & Index
2. Existing Site Conditions
3. Operations Plan
4. Extraction Phasing
5. Reclamation Plan
6. Cross Section & Details

RECEIVED

JAN 28 2021

RACINE COUNTY

TITLE & INDEX

Payne & Dolan, Inc.
N3 W23650 Badinger Rd
Waukesha, WI 53187



NOTES:

PROJECT:
Nonmetallic Mineral Extraction and Reclamation
Clearwater Acres LLP
Town of Waterford, Racine County, Wisconsin

BY	DATE	REVISION

DATE: 10/10/2016	DRAWN BY: EJC	DRAWING #:	SCALE:
---------------------	------------------	------------	--------

1

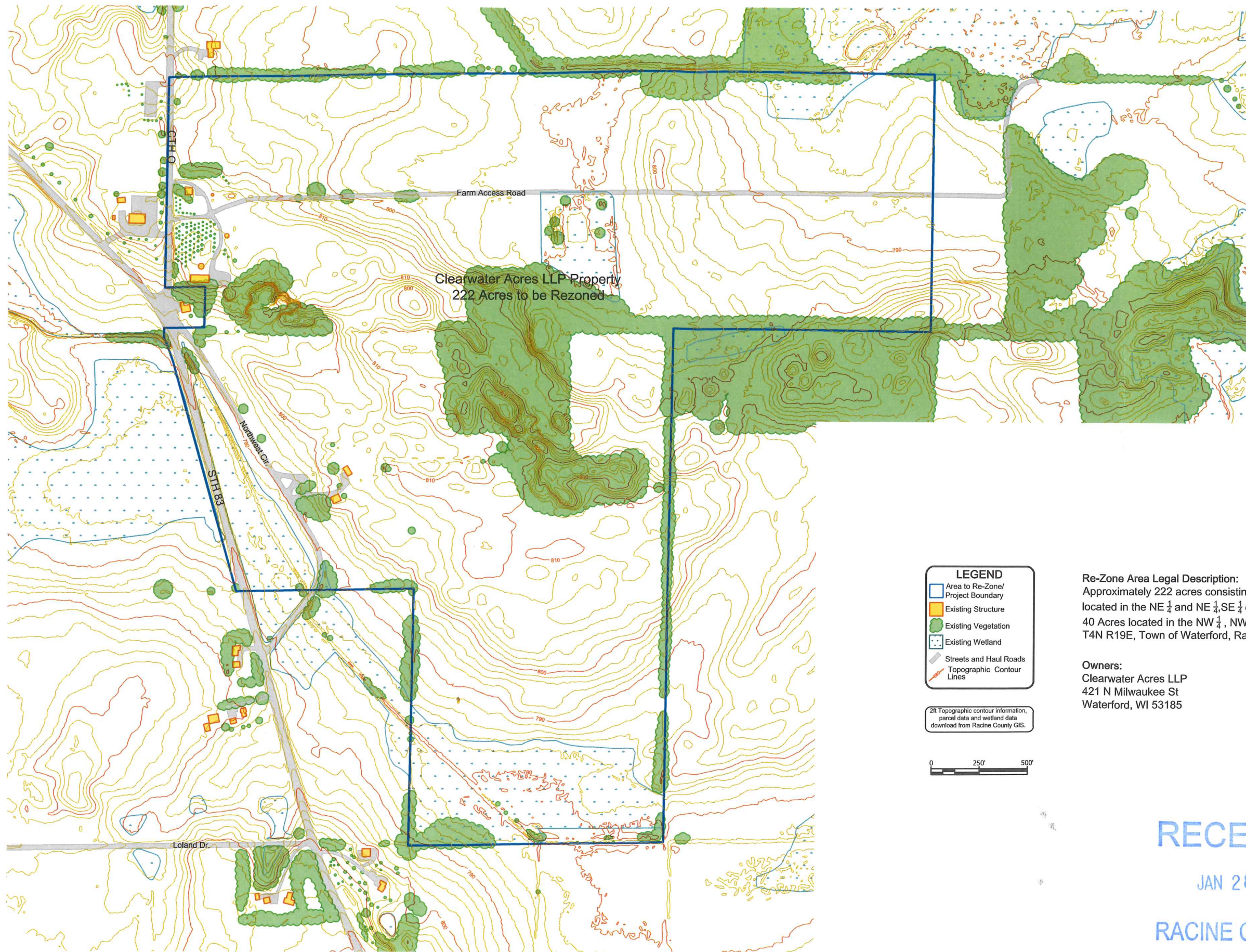

Clearwater Acres LLP Property
222 Acres to be Rezoned

LEGEND

- Area to Re-Zone/
Project Boundary
- Existing Structure
- Existing Vegetation
- Existing Wetland
- Streets and Haul Roads
- Topographic Contour Lines

2ft Topographic contour information, parcel data and wetland data download from Racine County GIS.

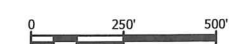

Re-Zone Area Legal Description:
Approximately 222 acres consisting of 182 acres located in the NE 1/4 and NE 1/4, SE 1/4 of Section 17 and 40 Acres located in the NW 1/4, NW 1/4 of Section 16. T4N R19E, Town of Waterford, Racine County.

Owners:
Clearwater Acres LLP
421 N Milwaukee St
Waterford, WI 53185

RECEIVED

JAN 28 2021

RACINE COUNTY

EXISTING SITE CONDITIONS

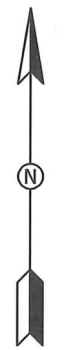

NOTES:

PROJECT:
Nonmetallic Mineral Extraction and Reclamation
Clearwater Acres LLP
Town of Waterford, Racine County, Wisconsin

BY	DATE	REVISION

DATE: 10/10/2016	DRAWN BY: EJC	DRAWING #:	SCALE:
---------------------	------------------	------------	--------

2



Payne & Dolan, Inc.
N3 W23650 Badinger Rd
Waukesha, WI 53187

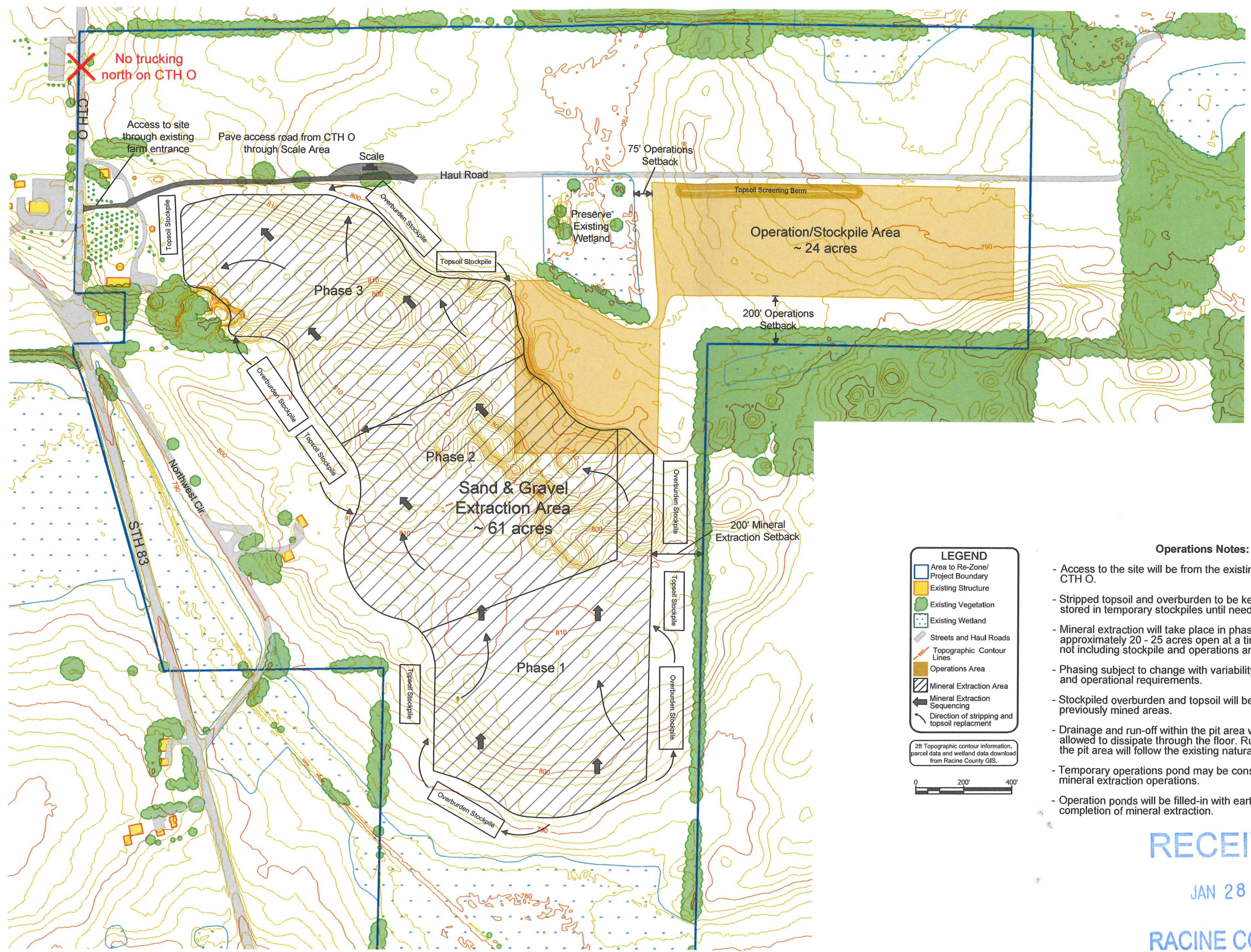

LEGEND

- Area to Re-Zone/Project Boundary
- Existing Structure
- Existing Vegetation
- Existing Wetland
- Streets and Haul Roads
- Topographic Contour Lines
- Operations Area
- Mineral Extraction Area
- Mineral Extraction Sequencing
- Direction of stripping and topsoil replacement

2ft Topographic contour information, parcel data and wetland data download from Racine County GIS.

0 200' 400'

Operations Notes:

- Access to the site will be from the existing entrance along CTH O.
- Stripped topsoil and overburden to be kept separate and stored in temporary stockpiles until needed for reclamation.
- Mineral extraction will take place in phases, with approximately 20 - 25 acres open at a time. Open acreage not including stockpile and operations area.
- Phasing subject to change with variability in mineral deposit and operational requirements.
- Stockpiled overburden and topsoil will be used to reclaim the previously mined areas.
- Drainage and run-off within the pit area will be internal and allowed to dissipate through the floor. Run-off from outside the pit area will follow the existing natural drainage patterns.
- Temporary operations pond may be constructed during mineral extraction operations.
- Operation ponds will be filled-in with earth materials upon completion of mineral extraction.

RECEIVED

JAN 28 2021

RACINE COUNTY
OPERATIONS PLAN

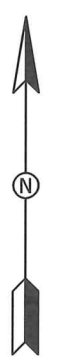

Payne & Dolan, Inc.
N3 W23650 Badinger Rd
Waukesha, WI 53187



NOTES:

PROJECT:
Nonmetallic Mineral Extraction and Reclamation
Clearwater Acres LLP
Town of Waterford, Racine County, Wisconsin

BY	DATE	REVISION

DATE: 10/10/2016	DRAWN BY: EJC	DRAWING #:	SCALE:
---------------------	------------------	------------	--------

3

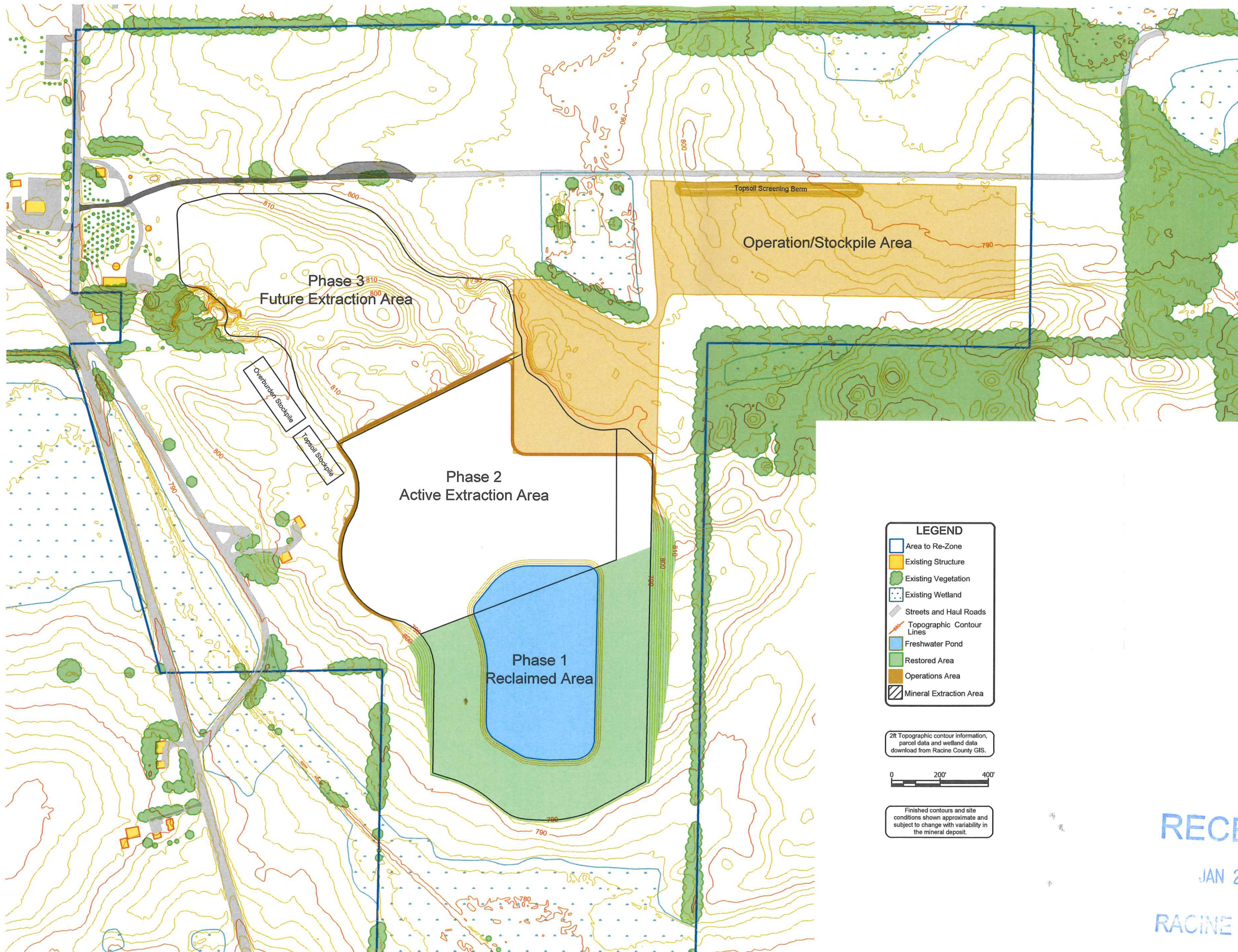

- LEGEND**
- Area to Re-Zone
 - Existing Structure
 - Existing Vegetation
 - Existing Wetland
 - Streets and Haul Roads
 - ~ Topographic Contour Lines
 - Freshwater Pond
 - Restored Area
 - Operations Area
 - Mineral Extraction Area

2R Topographic contour information, parcel data and wetland data download from Racine County GIS.

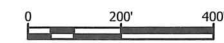

Finished contours and site conditions shown approximate and subject to change with variability in the mineral deposit.

RECEIVED

JAN 28 2021

RACINE COUNTY

EXTRACTION PHASING



NOTES:

PROJECT:
Nonmetallic Mineral Extraction and Reclamation
 Clearwater Acres LLP
 Town of Waterford, Racine County, Wisconsin

BY	DATE	REVISION

DATE: 10/10/2016	DRAWN BY: EJC	DRAWING #:	SCALE:
---------------------	------------------	------------	--------

4

Payne & Dolan, Inc.
 N3 W23650 Badinger Rd
 Waukesha, WI 53187



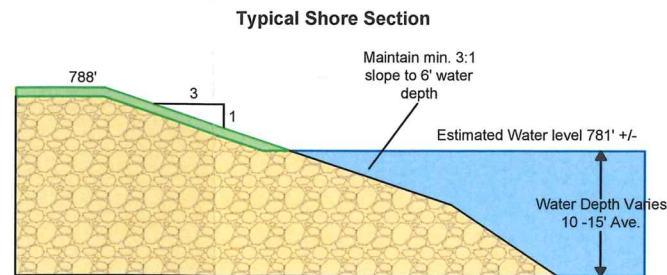
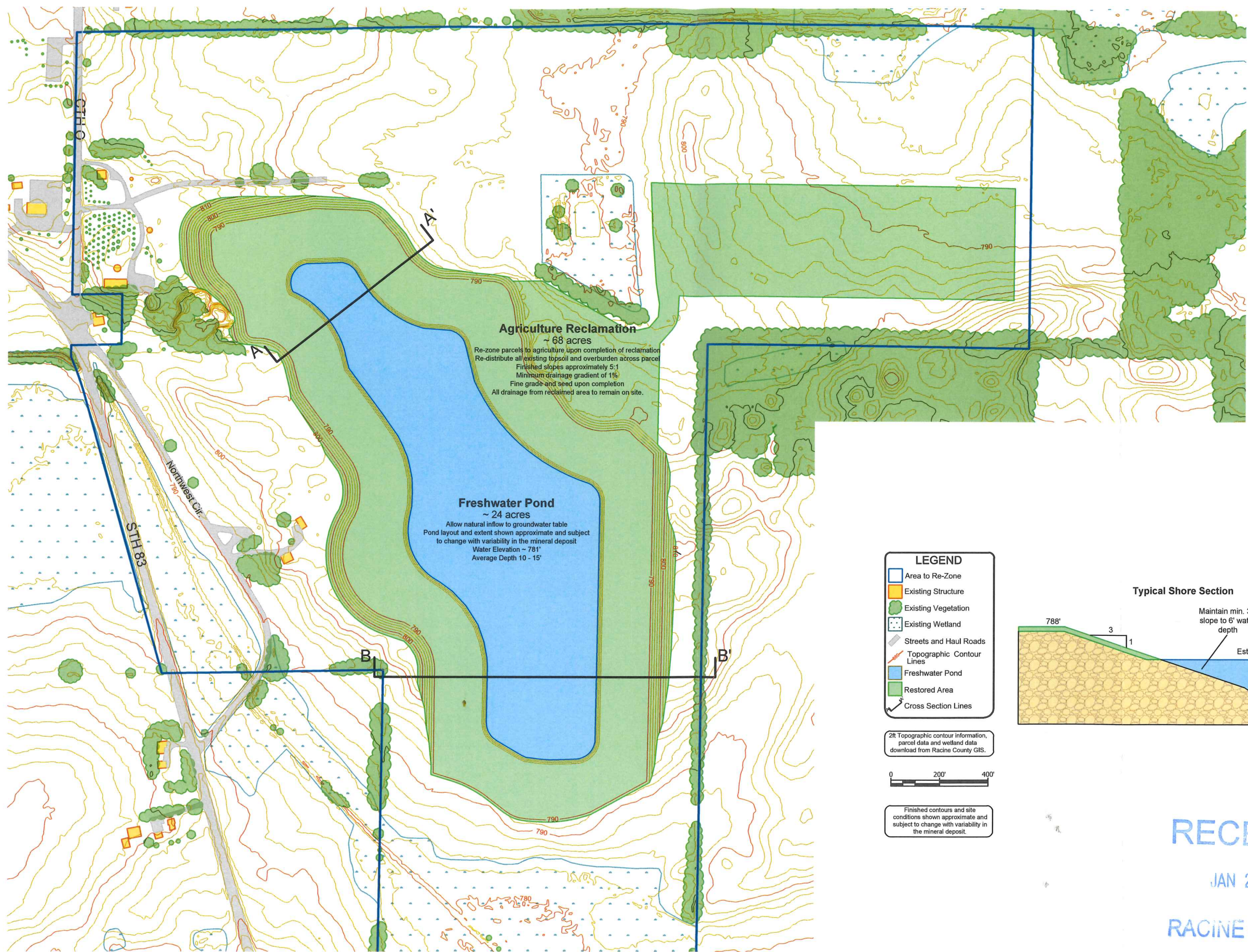

NOTES:

PROJECT:
Nonmetallic Mineral Extraction and Reclamation
Clearwater Acres LLP
Town of Waterford, Racine County, Wisconsin

BY	DATE	REVISION

DATE: 10/10/2016
DRAWN BY: EJC
DRAWING #:
SCALE:

RECEIVED
JAN 28 2021
RACINE COUNTY
RECLAMATION PLAN

5

Payne & Dolan, Inc.
N3 W23650 Badinger Rd
Waukesha, WI 53187



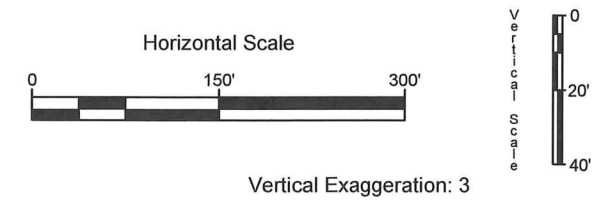
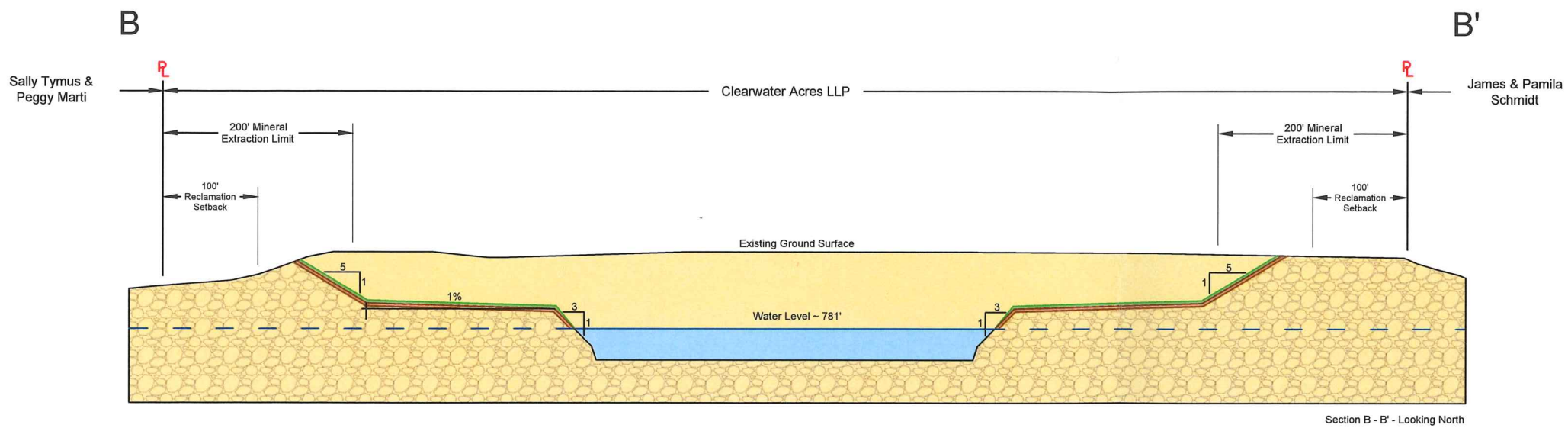
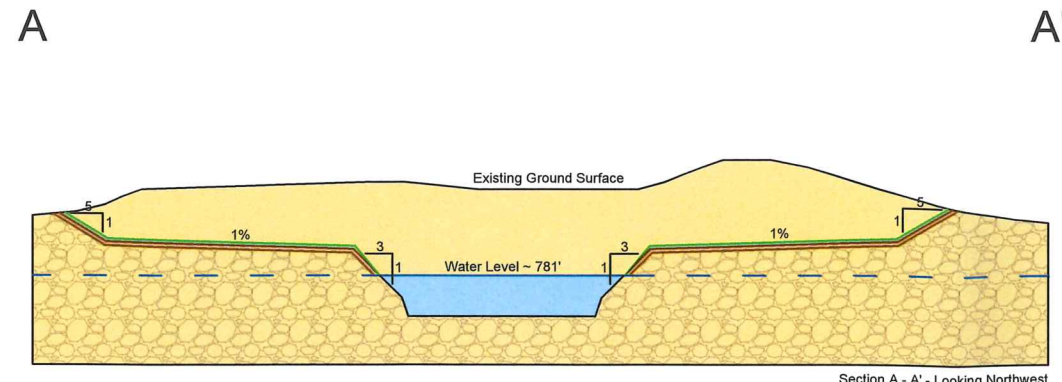

RECEIVED
 JAN 28 2021
 RACINE COUNTY

CROSS SECTION

TOPSOIL PRESERVATION

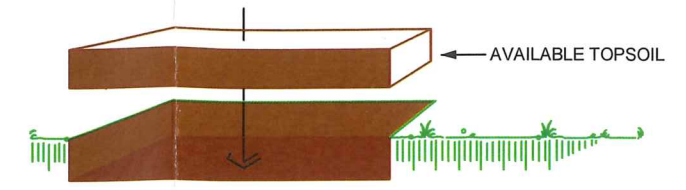

- Retain existing topsoil for distribution during reclamation.
- Store topsoil in temporary berms during mineral extraction.
- Stockpiled topsoil to be spread over graded slopes to the finished grade.
- Site Manager shall approve finished grade and uniform slopes prior to the sowing of seed.

RESTORED SLOPES

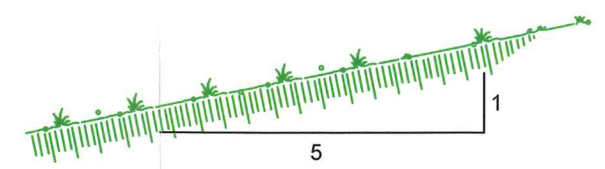

- Restored pit slopes to be graded no steeper than 5:1 (H:V) slopes.

RESTORED SLOPES - SHEET DRAINAGE

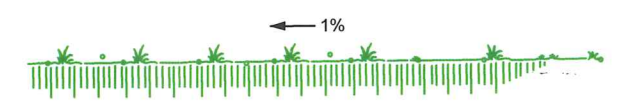

- Pit floor to be restored no flatter than a 1%, but no greater than a 5:1 slope, to internally drain into pond.

SEEDING OPERATIONS

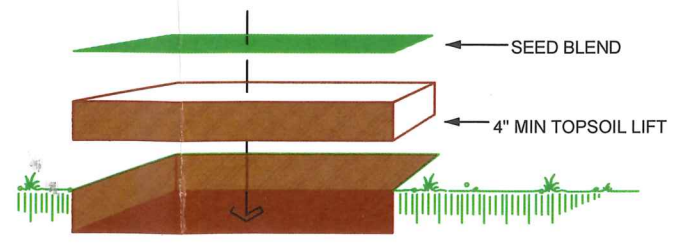

- Seeding shall occur on topsoiled, finished grade.
- All seeding will be done in accordance with the State of Wisconsin DOT Standard Specifications for Seeding and Mulching, Section 630 and 627.
- Seeding to be completed within 30 days of final topsoil grading.

Payne & Dolan, Inc.
 N3 W23650 Badinger Rd
 Waukesha, WI 53187



NOTES:

PROJECT:
 Nonmetallic Mineral Extraction and Reclamation
 Clearwater Acres LLP
 Town of Waterford, Racine County, Wisconsin

DATE	REVISION

DATE: 10/10/2016	DRAWN BY: EJC	DRAWING #:	SCALE:
---------------------	------------------	------------	--------

6

DETAILS