

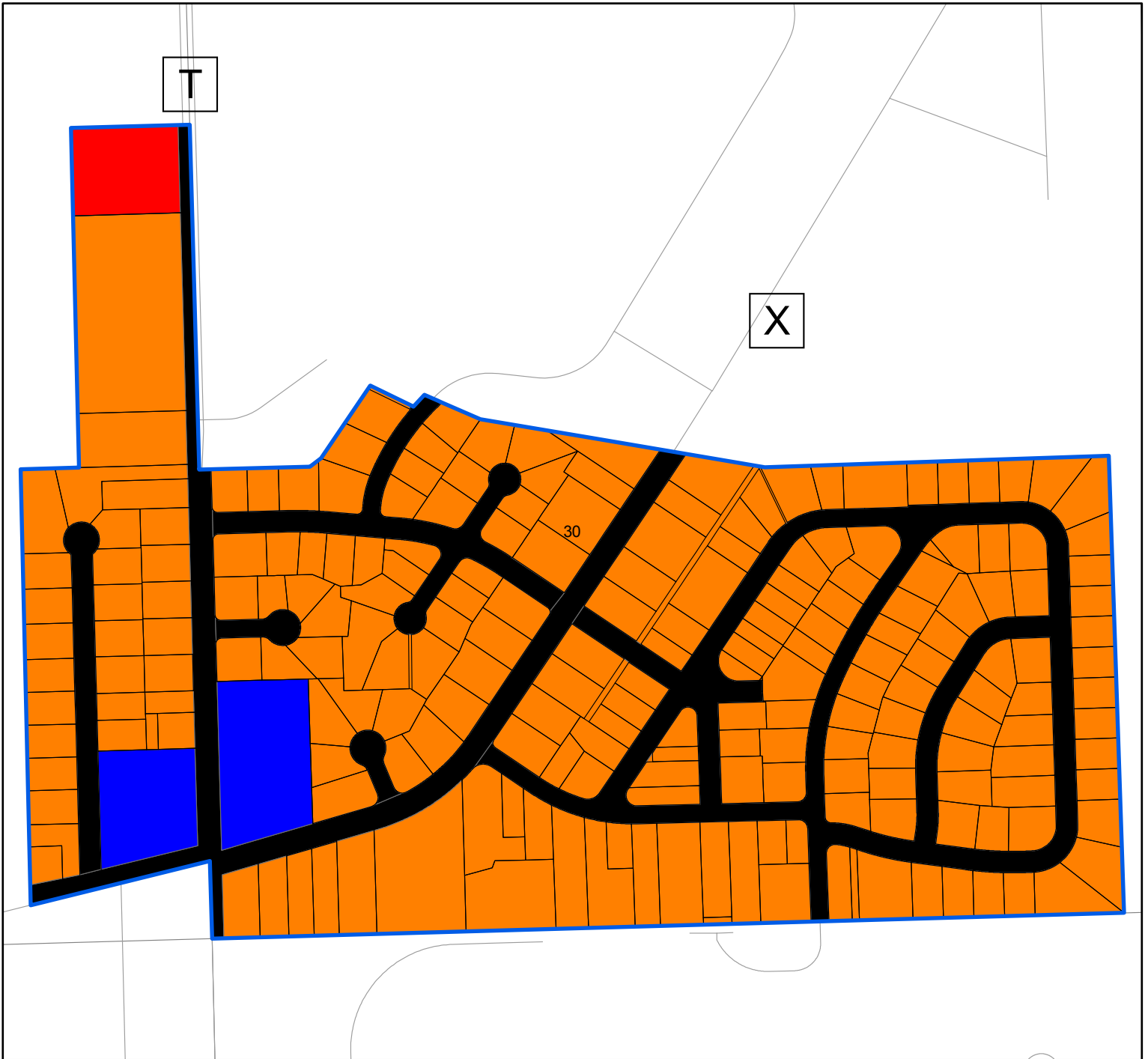

RECOMMENDED LAND USE PLAN FOR THE VILLAGE OF ELMWOOD PARK: 2035



 MEDIUM DENSITY RESIDENTIAL
(6,200 SQ. FT. TO 18,999 SQ. FT. PER DWELLING UNIT)

 GOVERNMENTAL AND INSTITUTIONAL

 COMMERCIAL

 VILLAGE BOUNDARY

 STREETS AND HIGHWAYS

 PARCEL LINE



0 200 400
Feet

1 inch = 400 feet